



| | | | |
|-----|----------|----|------------|
| NO. | DATE | BY | REVISION |
| 4 | 22/08/22 | CS | NPL UPDATE |
| 3 | 21/07/16 | PP | EDB UPDATE |
| | | | |

SHEET 1 OF 3
 EDBSK3A0225KB3S
 4.0 httpd 2026/04/02 07:39

| | |
|--------|---|
| TITLE: | 3PH DISTRIBUTION TRANSFORMER NAMEPLATE INFORMATION |
| DES: | JWEN |
| DATE: | 15/11/17 |
| SCALE: | NTS |

POWER SOLUTIONS

Guelph, ONT Compton, CA
 Hyderabad, IN Compton, CA

HPS Sentinel™ K

Energy Efficient Distribution Transformer

Transformateur de Distribution à Bon Rendement Énergétique

Baraboo, WI Monterrey, MX

Part No. SK3A0225KB3S

LR 3902

DRY TYPE TRANSFORMER E112313

ALSO VERIFIED IN ACCORDANCE TO ENERGY STANDARD CRO22-18 BY UNDERWRIERS LABORATORIES INC. © 306

LISTED

| | | | | | | |
|----------------------------|--------------|-----------|-------|-----------------|----------------------------|---------------------------------|
| Cust. Ref. | Serial No. | HV/HT | VOLTS | CURRENT COURANT | % RATED VOLTAGE % NOMINALE | CONNECTION CONNECTION PAR PHASE |
| Ref. du Client | No. de Serie | | | | | |
| Phase | 3 | 480V | 504 | 258 | 105 | 1 |
| Type | K | 10 kV | 492 | 264 | 102.5 | 2 |
| Cooling Refroidissement | ANN | H1 H2 H3 | 480 | 271 | 100 | 3 |
| kVA | 225 | 208Y/120V | 468 | 278 | 97.5 | 4 |
| Temp. Rise Echauffement | 150 °C | | 456 | 285 | 95 | 5 |
| Temp Class | 220 °C | | 444 | 293 | 92.5 | 6 |
| Winding Enroulement | AL | | 432 | 301 | 90 | 7 |
| Frequency | 60 | | | | | |
| Impedance % @ 170 °C | 5.2 | | | | | |
| Encl Type Type De Coffrage | 3R | | | | | |
| Weight lbs/kg Poids | 1650/749 | | | | | |

Spacings between any ventilated enclosure panel and any adjacent wall shall be a minimum of 5 inches except when wall mounted using approved wall mounting kit electrostatic shield

SEISMIC QUALIFICATIONS:
 AS FLOOR MOUNT ONLY
 IBC 2018/ASCE 7-16
 SDS<=2.0g Z/n=0 Ip=1.5

d000187hb



All Dimensions in inches

ENCLOSURE COLOR :ANSI 61 GREY – OUTDOOR

H.V.1. TERMINAL DETAIL

L.V.1. TERMINAL DETAIL

MECHANICAL TYPE LUGS INCLUDED
SUITABLE FOR 350MCM-6 CU/AL
CONDUCTORS
2 CONDUCTORS PER PHASE

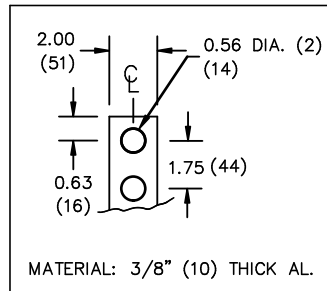

CUSTOMER NOTES:

- HV1 TERMINATED AT TOP FRONT
- LV1 TERMINATED AT BOTTOM FRONT



TITLE: 3PH DISTRIBUTION TRANSFORMER

| | | | | |
|-----|----------|----|------------|----------------|
| 4 | 22/08/22 | CS | NPL UPDATE | DES: JWEN |
| 3 | 21/07/16 | PP | EDB UPDATE | DATE: 15/11/17 |
| NO. | DATE | BY | REVISION | SCALE: NTS |

SHEET 2 OF 3

EDBSK3A0225KB35

ENCLOSURE BOTTOM VIEW

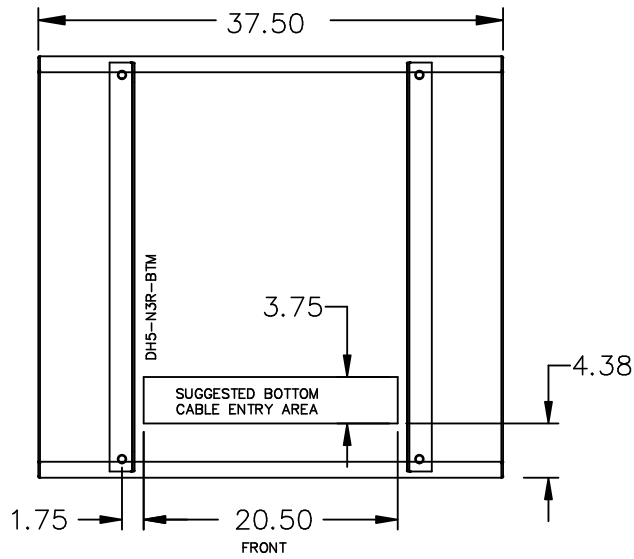

NOTE:
 WHEN BOTTOM CABLE ENTRY IS OPTED, THE SPACE USED FOR CONDUITS IN THE FRONT OF THE TRANSFORMER SHOULD NOT OBSTRUCT MORE THAN 50% OF THE FRONT AIR INTAKE AREA DEFINED BETWEEN THE BOTTOM PLATE AND THE SUPPORTING LEGS.
 SEE MANUAL FOR ADDITIONAL INFORMATION



TITLE: 3PH DISTRIBUTION TRANSFORMER
 ENCLOSURE BOTTOM VIEW

| | | | | |
|-----|----------|----|------------|----------------|
| 4 | 22/08/22 | CS | NPL UPDATE | DES: JWEN |
| 3 | 21/07/16 | PP | EDB UPDATE | DATE: 15/11/17 |
| NO. | DATE | BY | REVISION | SCALE: NTS |

SHEET 3 OF 3

EDBSK3A0225KB3S