



TITLE: 1PH DISTRIBUTION TRANSFORMER
NAMEPLATE INFORMATION

NO.	DATE	BY	REVISION	SCALE:
2	21/07/16	PP	EDB UPDATE	DES: PPICASSI
1	20/03/17	PP	SEISMIC UPDATE	DATE: 17/04/27
				SCALE: NTS

SHEET 1 OF 3

EDB SG3L0075PEOC

2.0 httpd 2026/04/03 00:41

POWER SOLUTIONS
Guelph, ONT
Hyderabad, IN Compton, CA

HPS Sentinel™ G
Energy Efficient Distribution Transformer
Transformateur de Distribution à Bon Rendement Énergétique

Baraboo, WI
Monterrey, MX

Part No. **SG3L0075PEOC**

Cust. Ref. [] Serial No. []
Ref. du Client [] No. de Serie []

Phase 1 HV/HT 600V 125A

Type F BIL 10 kV

Cooling Refroidissement ANN Term Bornes H1 H2

kVA 75 LV/BT 120/240V 625/312A

Temp. Rise Echauffement 150 °C BIL 10 kV

Temp Class Classe Temp 220 °C Term Bornes X4 X2 X3 X1

Winding Enroulement CU Energy Regulations DOE 10 CFR PART 431:2016

Frequency Fréquence Hz 60 Reglements de l'Énergétique CEE ACT SOR/2018-201

Impedance % @ 170 °C 6

Encl. Type Type de Coffrage 3R

Weight Poids lbs/kg 525/239

VOLTS	CURRENT COURANT	% RATED % TENSION NOMINALE	CONNECTION EACH PHASE CONNECTION PAR PHASE
630	119	105	1-2
615	122	102.5	2-3
600	125	100	3-4
585	128	97.5	4-5
570	132	95	5-6
120	625		X4&X2, X3&X1
240	312.5		X1, X4

SEISMIC QUALIFICATIONS: OSP-0136-10
QUALIFICATIONS SISMOSES. MONTAGE AU SOL SEULEMENT
OSP-0136-10 IBC 2012/ASCE 7-10
SDS<=2.0g Z/H=1 IP=1.5
FLOOR MOUNT ONLY

SEISMIC QUALIFICATIONS:
AS FLOOR MOUNT ONLY
IBC 2018/ASCE 7-16
SDS<=2.0g Z/h=1 Ip=1.5

0000186hb

LR 3902

UL LISTED

DRY TYPE
TRANSFORMER
77US
E112313

8 0342314171

ALSO REFER TO THE IBC CODES
TO ENERGY STANDARDS C920-18
BY UNDERWRITERS LABORATORIES INC. @ 316

SPACINGS BETWEEN ANY VENTILATED ENCLOSURE PANEL AND ANY ADJACENT WALL SHALL BE A MINIMUM OF 3 INCHES
ESPACEMENTS ENTRE LES PANNEAUX DE BOTTIER VENTILE ET LES MURS ADJACENT DOIVENT ÊTRE UN MINIMUM DE 3 POUNCES

SEISMIC QUALIFICATIONS: OSP-0136-10
QUALIFICATIONS SISMOSES. MONTAGE AU SOL SEULEMENT
OSP-0136-10 IBC 2012/ASCE 7-10
SDS<=2.0g Z/H=1 IP=1.5
FLOOR MOUNT ONLY

SEISMIC QUALIFICATIONS:
AS FLOOR MOUNT ONLY
IBC 2018/ASCE 7-16
SDS<=2.0g Z/h=1 Ip=1.5



All Dimensions in inches

ENCLOSURE COLOR :ANSI 61 GREY – OUTDOOR

HV TERMINAL DETAIL

LV TERMINAL DETAIL

MECHANICAL TYPE LUGS INCLUDED
SUITABLE FOR 250MCM-6 CU/AL
CONDUCTORS
1 CONDUCTOR PER PHASE

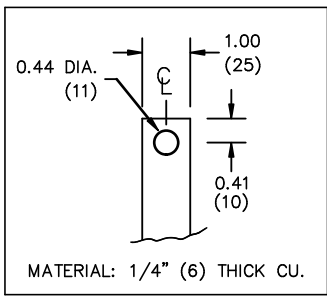

CUSTOMER NOTES:

- HV TERMINATED AT TOP FRONT
- LV TERMINATED AT BOTTOM FRONT



TITLE: 1PH DISTRIBUTION TRANSFORMER

2	21/07/16	PP	EDB UPDATE	DES: PPICASSI
1	20/03/17	PP	SEISMIC UPDATE	DATE: 17/04/27
NO.	DATE	BY	REVISION	SCALE: NTS

SHEET 2 OF 3

EDBSC310075PEOC

ENCLOSURE BOTTOM VIEW



NOTE:
 WHEN BOTTOM CABLE ENTRY IS OPTED, THE SPACE USED FOR CONDUITS IN THE FRONT OF THE TRANSFORMER SHOULD NOT OBSTRUCT MORE THAN 50% OF THE FRONT AIR INTAKE AREA DEFINED BETWEEN THE BOTTOM PLATE AND THE SUPPORTING LEGS.
 SEE MANUAL FOR ADDITIONAL INFORMATION



TITLE: 1PH DISTRIBUTION TRANSFORMER
 ENCLOSURE BOTTOM VIEW

2	21/07/16	PP	EDB UPDATE	DES: PPICASSI
1	20/03/17	PP	SEISMIC UPDATE	DATE: 17/04/27
NO.	DATE	BY	REVISION	SCALE: NTS

SHEET 3 OF 3

EDBSC310075PEOC