



TITLE: 3PH DISTRIBUTION TRANSFORMER
NAMEPLATE INFORMATION

NO.	DATE	BY	REVISION
3	21/07/16	PP	EDB UPDATE
2	20/03/17	PP	SEISMIC UPDATE
			DES: RMOVVA
			DATE: 16/08/26
			SCALE: NTS

SHEET 1 OF 3

EDB SG3A0150DBOC

3.0 httpd 2026/05/17 06:37

POWER SOLUTIONS
Guelph, ONT
Hyderabad, IN Compton, CA

HPS Sentinel™ G
Energy Efficient Distribution Transformer
Transformateur de Distribution à Bon Rendement Énergétique

Baraboo, WI
Monterrey, MX

Part No. **SG3A0150DBOC**

Cust. Ref. _____
Ref. du Client _____

Phase **3**

Type **K**

Cooling **ANN**
Refroidissement _____

kVA **150**

Temp. Rise **150 °C**
Échauffement _____

Temp Class **220 °C**
Classe Temp _____

Winding **CU**
Enroulement _____

Frequency **60**
Fréquence Hz _____

Impedance **5.4**
% @ 170 °C _____

Encl. Type **3R**
Type de Coffrage _____

Weight **1050**
Poids _____

Serial No. _____
No. de Serie _____

HV/HT **240V**

BIL **10 kV**

Term Bornes **H1 H2 H3**

LV/BT **208Y/120V**

BIL **10 kV**

Term Bornes **X0 X1 X2 X3**

Energy Regulations **DOE 10 CFR PART 431:2016**

Reglements de l'Energétique **CEE ACT SOR/2018-201**

DRY TYPE TRANSFORMER
77US
E112313

LR 3902

0342317260

ALSO REFER TO ENERGY STANDARDS CRO20-18
BY UNDERWRITERS LABORATORIES INC. 0148

LISTED

SPACINGS BETWEEN ANY VENTILATED ENCLOSURE PANEL AND ANY ADJACENT WALL SHALL BE A MINIMUM OF 5 INCHES EXCEPT WHEN WALL MOUNTED USING APPROVED WALL MOUNTING KIT

VOLTS	CURRENT COURANT	% RATED VOLTAGE % TENSION NOMINALE	CONNECTION EACH PHASE CONNECTION PAR PHASE
252	344	105	1
246	352	102.5	2
240	361	100	3
234	370	97.5	4
228	380	95	5
222	390	92.5	6
216	401	90	7

SEISMIC QUALIFICATIONS:
AS FLOOR MOUNT ONLY
IBC 2018/ASCE 7-16
SDS<=2.0g Z/h=1 Ip=1.5

d000186hb

THIS DRAWING CONTAINS STRICTLY CONFIDENTIAL INFORMATION BELONGING TO HAMMOND POWER SOLUTIONS AND MUST NOT BE DISTRIBUTED OUTSIDE AUTHORIZED PARTIES.



All Dimensions in inches

ENCLOSURE COLOR :ANSI 61 GREY – OUTDOOR

H.V.1. TERMINAL DETAIL

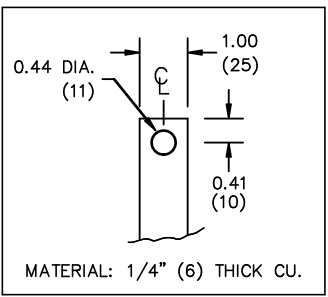

L.V.1. TERMINAL DETAIL

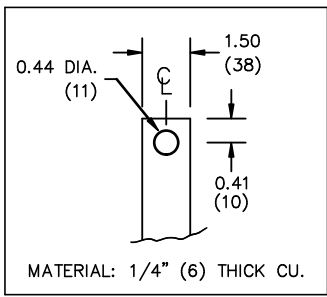

- CUSTOMER NOTES:
- HV1 TERMINATED AT TOP FRONT
 - LV1 TERMINATED AT BOTTOM FRONT



TITLE: 3PH DISTRIBUTION TRANSFORMER				
3	21/07/16	PP	EDB UPDATE	DES: RMOVVA
2	20/03/17	PP	SEISMIC UPDATE	DATE: 16/08/26
NO.	DATE	BY	REVISION	SCALE: NTS

SHEET 2 OF 3
EDBSC3A0150DBOC
3.0 httpd 2026/05/17 06:37



NOTE:
 WHEN BOTTOM CABLE ENTRY IS OPTED, THE SPACE USED FOR CONDUITS IN THE FRONT OF THE TRANSFORMER SHOULD NOT OBSTRUCT MORE THAN 50% OF THE FRONT AIR INTAKE AREA DEFINED BETWEEN THE BOTTOM PLATE AND THE SUPPORTING LEGS.
 SEE MANUAL FOR ADDITIONAL INFORMATION



TITLE: 3PH DISTRIBUTION TRANSFORMER
 ENCLOSURE BOTTOM VIEW

3	21/07/16	PP	EDB UPDATE	DES: RMOVVA
2	20/03/17	PP	SEISMIC UPDATE	DATE: 16/08/26
NO.	DATE	BY	REVISION	SCALE: NTS

SHEET 3 OF 3

EDBSC3A0150DBOC