

hammond
POWER SOLUTIONS



GUELPH, ONT. BARABOO, WI COMPTON, CA MONTERREY, MX



LR 3902
GENERAL PURPOSE TRANSFORMER 252L E50394

**HPS UNIVERSAL™
DRY TYPE ISOLATION/BUCK-BOOST TRANSFORMER**

HV/HT	120X240V				Cust. Ref. Réf. du client	
BIL	-				Serial No. No. de série	
TERM. BORNES	H4 H2 H3 H1				Part No. No. de pièce	Q005ESCF
	VOLTS	CURRENT COURANT	% RATED VOLTAGE % TENSION NOMINALE	CONNECTION EACH PHASE CONNEXION PAR PHASE	PHASE	1
					kVA	5
					TYPE	Q
					Cooling Refroidissement	ANC
					Temp. Rise Echauffement	115 °C
					Temp. Class Classe de Temp.	180 °C
					Frequency Fréquence	50/60Hz
LV/BT	16/32V				Impédance % @ 135 °C	3.2
BIL	-				Encl. Type Type de boîtier	3R
TERM. BORNES	X1	X3	X2	X4	Wt Poids lbs	105
					Winding Enroulement	CU

This transformer can be wired as both an isolation transformer and buck-boost transformer. Refer to wiring instruction for details.

0001073bn



hammond
POWER SOLUTIONS

TITLE: 1PH BUCK BOOST TRANSFORMER
NAMEPLATE INFORMATION

1	21/07/13	PP	EDB UPDATE	DES: WWONG
NO.	DATE	BY	REVISION	SCALE: NTS

SHEET 1 OF 2

EDBQ005ESCF

FRONT VIEW

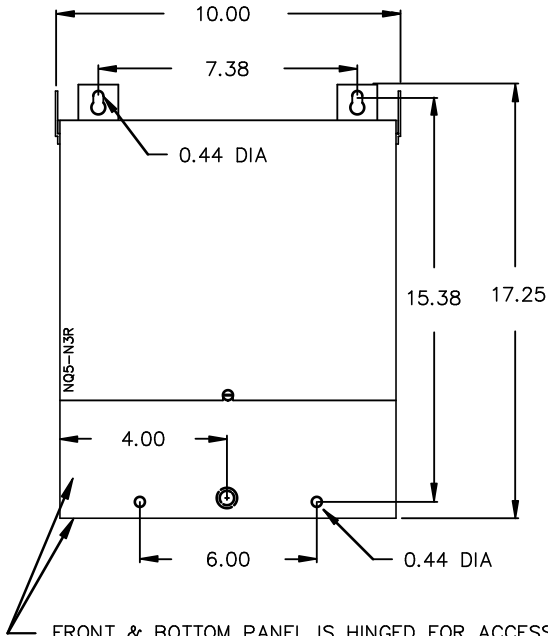

SIDE VIEW

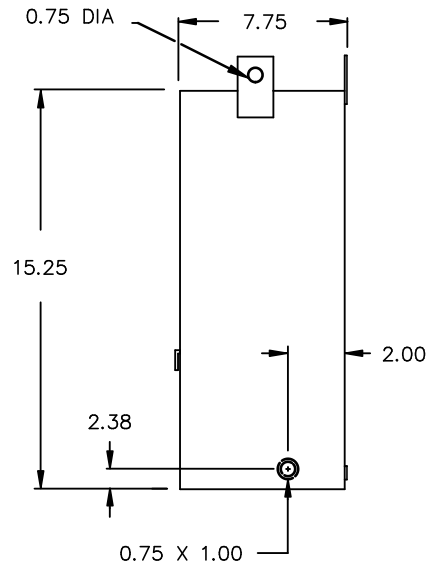

FRONT & BOTTOM PANEL IS HINGED FOR ACCESS TO TERMINALS, BOTTOM MOUNTING HOLES AND REAR KNOCKOUT.

All Dimensions in inches

ENCLOSURE COLOR : ANSI 61 GREY – OUTDOOR

CUSTOMER NOTES:



TITLE: 1PH BUCK BOOST TRANSFORMER

1	21/07/13	PP	EDB UPDATE	DES: WWONG
NO.	DATE	BY	REVISION	SCALE: NTS

SHEET 2 OF 2

EDB0005ESCF