

**hammond**  
POWER SOLUTIONS



GUELPH, ONT. BARABOO,WI COMPTON,CA MONTERREY,MX



LR 3902  
GENERAL PURPOSE TRANSFORMER  
252L  
E50394

**HPS UNIVERSAL™**

**DRY TYPE ISOLATION/BUCK-BOOST TRANSFORMER**

HV/HT	120X240V				Cust. Ref. Réf. du client	Q005ERCF
BIL	-				Serial No. No. de série	
TERM. BORNES	H4 H2 H3 H1				Part No. No. de pièce	Q005ERCF
	VOLTS	CURRENT COURANT	% RATED VOLTAGE % TENSION NOMINALE	CONNECTION EACH PHASE CONNEXION PAR PHASE	PHASE	1
					kVA	5
					TYPE	Q
					Cooling Refroidissement	ANC
					Temp. Rise Echauffement	115 °C
					Temp. Class Classe de Temp.	180 °C
					Frequency Fréquence	50/60Hz
LV/BT	12/24V				Impédance % @ 135 °C	3.2
BIL	-				Encl. Type Type de boîtier	3R
TERM. BORNES	X1	X3	X2	X4	Wt Poids lbs	105
					Winding Enroulement	CU

This transformer can be wired as both an isolation transformer and buck-boost transformer. Refer to wiring instruction for details.

0001073bn



**hammond**  
POWER SOLUTIONS

TITLE: 1PH BUCK BOOST TRANSFORMER  
NAMEPLATE INFORMATION

2	21/07/13	PP	EDB UPDATE	DES: WWONG
1	15/06/09	LC	CHANGED ADD TERMINATION	DATE: 03/10/28
NO.	DATE	BY	REVISION	SCALE: NTS

SHEET 1 OF 2

EDB0005ERCF

THIS DRAWING CONTAINS STRICTLY CONFIDENTIAL INFORMATION BELONGING TO HAMMOND POWER SOLUTIONS AND MUST NOT BE DISTRIBUTED OUTSIDE AUTHORIZED PARTIES.  
2.0 httpd 2026/04/03 18:28

FRONT VIEW

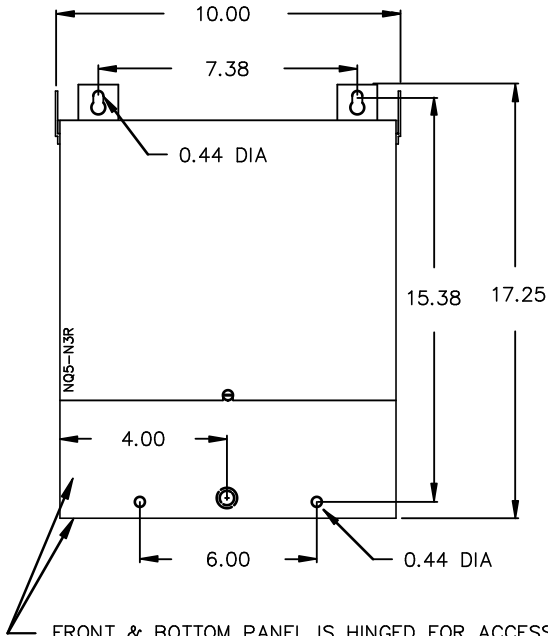

SIDE VIEW

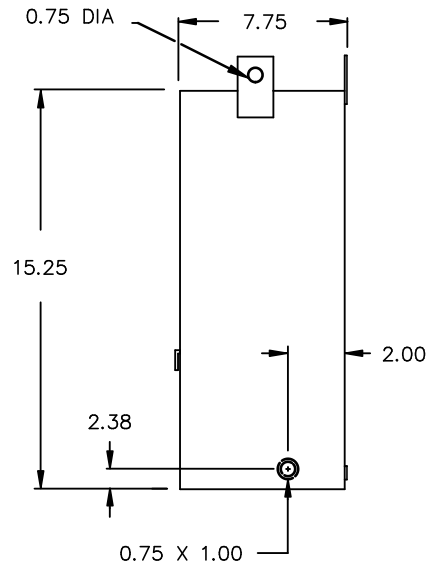

FRONT & BOTTOM PANEL IS HINGED FOR ACCESS TO TERMINALS, BOTTOM MOUNTING HOLES AND REAR KNOCKOUT.

All Dimensions in inches

ENCLOSURE COLOR : ANSI 61 GREY – OUTDOOR

L.V.1. TERMINAL DETAIL

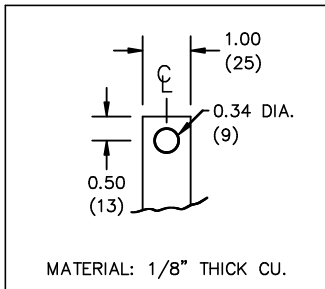

CUSTOMER NOTES:

- HV1 TERMINATED AT #10SEW LEADS

THIS DRAWING CONTAINS STRICTLY CONFIDENTIAL INFORMATION BELONGING TO HAMMOND POWER SOLUTIONS AND MUST NOT BE DISTRIBUTED OUTSIDE AUTHORIZED PARTIES.



TITLE: 1PH BUCK BOOST TRANSFORMER

2	21/07/13	PP	EDB UPDATE	DES: WWONG
1	15/06/09	LC	CHANGED ADD TERMINATION	DATE: 03/10/28
NO.	DATE	BY	REVISION	SCALE: NTS

SHEET 2 OF 2

EDB0005ERCF

2.0 httpd 2026/04/03 18:28