

**hammond**  
POWER SOLUTIONS



GUELPH, ONT. BARABOO,WI COMPTON,CA MONTERREY,MX



LR 3902  
GENERAL PURPOSE TRANSFORMER  
252L  
E50394

**HPS UNIVERSAL™**  
DRY TYPE ISOLATION/BUCK-BOOST TRANSFORMER

HV/HT	240X480V				Cust. Ref. Réf. du client	
BIL	-				Serial No. No. de série	
TERM. BORNES	H4 H2 H3 H1				Part No. No. de pièce	Q005DTCF
	VOLTS	CURRENT COURANT	% RATED VOLTAGE % TENSION NOMINALE	CONNECTION EACH PHASE CONNEXION PAR PHASE	PHASE	1
					kVA	5
					TYPE	Q
					Cooling Refroidissement	ANC
					Temp. Rise Echauffement	115 °C
					Temp. Class Classe de Temp.	180 °C
					Frequency Fréquence	50/60Hz
LV/BT	24/48V				Impédance % @ 135 °C	3.2
BIL	-				Encl. Type Type de boîtier	3R
TERM. BORNES	X1	X3	X2	X4	Wt Poids lbs	105
					Winding Enroulement	CU

This transformer can be wired as both an isolation transformer and buck-boost transformer. Refer to wiring instruction for details.

SPACINGS BETWEEN ENCLOSURE PANEL AND ANY ADJACENT WALL SHALL BE A MINIMUM OF 1 INCHES

0001073bn



**hammond**  
POWER SOLUTIONS

TITLE: 1PH BUCK BOOST TRANSFORMER  
NAMEPLATE INFORMATION

1	21/07/13	PP	EDB UPDATE	DES: WWONG
NO.	DATE	BY	REVISION	SCALE: NTS

SHEET 1 OF 2

EDBQ005DTCF

FRONT VIEW

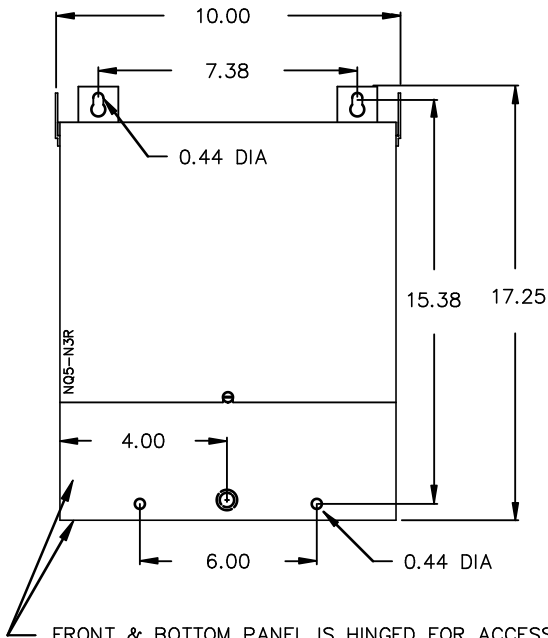

SIDE VIEW

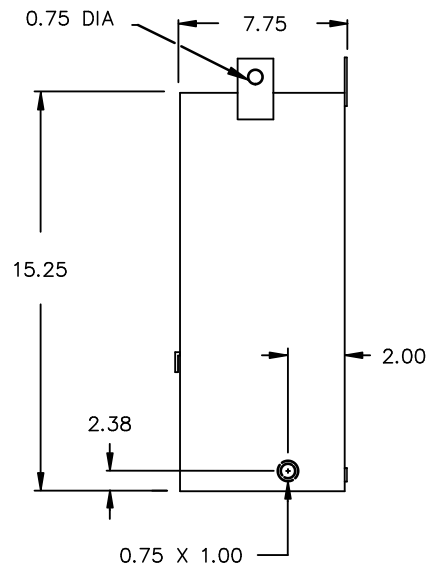

FRONT & BOTTOM PANEL IS HINGED FOR ACCESS TO TERMINALS, BOTTOM MOUNTING HOLES AND REAR KNOCKOUT.

All Dimensions in inches

ENCLOSURE COLOR : ANSI 61 GREY – OUTDOOR

L.V.1. TERMINAL DETAIL

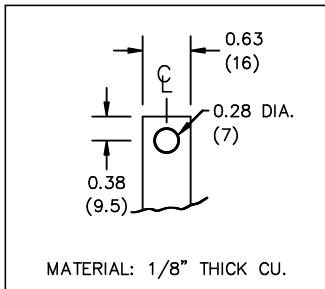

CUSTOMER NOTES:

- HV1 TERMINATED AT #14SEW LEADS



TITLE: 1PH BUCK BOOST TRANSFORMER

1	21/07/13	PP	EDB UPDATE	DES: WWONG
				DATE: 04/08/18
NO.	DATE	BY	REVISION	SCALE: NTS

SHEET 2 OF 2

EDB0005DTCF