

hammond
POWER SOLUTIONS



GUELPH, ONT. BARABOO,WI COMPTON,CA MONTERREY,MX



LR 3902
GENERAL PURPOSE TRANSFORMER
252L
E50394

HPS UNIVERSAL™
DRY TYPE ISOLATION/BUCK-BOOST TRANSFORMER

| | | | |
|--------------|-------------|--------------------------------|----------|
| HV/HT | 240X480V | Cust. Ref. Réf. du client | |
| BIL | - | Serial No. No. de série | |
| TERM. BORNES | H1 H3 H2 H4 | Part No. No. de pièce | Q002DTCF |
| | | PHASE | 1 |
| | | kVA | 2 |
| | | TYPE | Q |
| | | Cooling Refroidissement | ANC |
| | | Temp. Rise Echauffement | 115 °C |
| | | Temp. Class Classe de Temp. | 180 °C |
| | | Frequency Fréquence | 50/60Hz |
| | | Impédance % @ 135 °C | 3.3 |
| | | Encl. Type Type de boîtier | 3R |
| | | Wt Poids lbs/kg | 47/22 |
| | | Winding Enroulement | COPPER |

| VOLTS | CURRENT COURANT | % RATED VOLTAGE % TENSION NOMINALE | CONNECTION EACH PHASE CONNEXION PAR PHASE |
|-------|--------------------|---|--|
| | | | |

LV/BT: 24/48V

BIL: -

TERM. BORNES: X4 X2 X3 X1

This transformer can be wired as both an isolation transformer and buck-boost transformer. Refer to wiring instruction for details.

0001073bn



hammond
POWER SOLUTIONS

TITLE: 1 PHASE ENCAPSULATED TRANSFORMER
NAMEPLATE INFORMATION

| | | | | |
|-----|----------|----|------------------|----------------|
| 2 | 26/03/24 | LC | CHANGED NPL VER: | DES: WWONG |
| 1 | 21/07/13 | PP | EDB UPDATE | DATE: 03/12/19 |
| NO. | DATE | BY | REVISION | SCALE: NTS |

SHEET 1 OF 2

EDBQ002DTCF

FRONT VIEW



SIDE VIEW

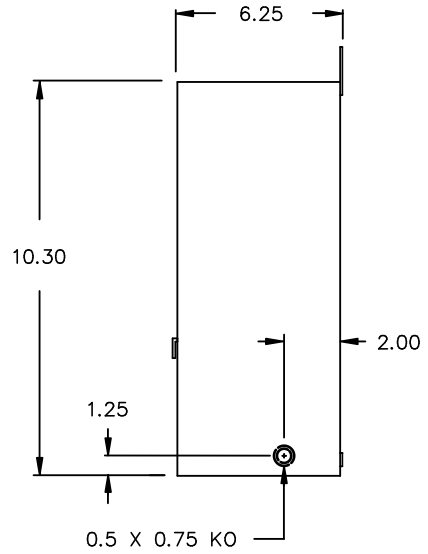

FRONT & BOTTOM PANEL IS HINGED FOR ACCESS TO TERMINALS, BOTTOM MOUNTING HOLES AND REAR KNOCKOUT.

All Dimensions in inches

ENCLOSURE COLOR : ANSI 61 GREY – OUTDOOR

LV TERMINAL DETAIL

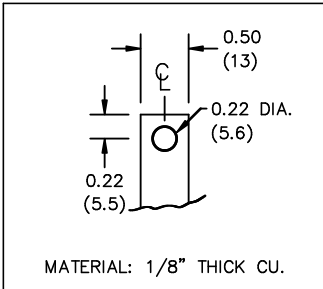

CUSTOMER NOTES:

- HV TERMINATED AT #18 AWG LEAD WIRE
- C/W WIRING CONNECTION CHART



TITLE: 1 PHASE ENCAPSULATED TRANSFORMER

| | | | | |
|-----|----------|----|------------------|----------------|
| 2 | 26/03/24 | LC | CHANGED NPL VER: | DES: WWONG |
| 1 | 21/07/13 | PP | EDB UPDATE | DATE: 03/12/19 |
| NO. | DATE | BY | REVISION | SCALE: NTS |

SHEET 2 OF 2

EDB0002DTCF