

- IMPEDANCE SHOWN IS CALCULATED VALUE

d000590hb

hammond POWER SOLUTIONS

hammond Distribution Transformer
Transformateur de Distribution

Serial No. _____
No. de Serie _____

Phase 3 HV/HT 4160V

Type K BIL 30 kV

Cooling Refroidissement AA Term Bornes H1 H2 H3

kVA 750 LV/BT 480Y/277V, 902A

Temp. Rise Echauffement 150 °C BIL 10 kV

Temp Class Classe Temp 220 °C Term Bornes X0 X1 X2 X3

Winding Enroulement CU Energy Regulations DOE 10 CFR PART 431:2016

Frequency Fréquence Hz 60 Reglements de Energetique CEE ACT SOR/2011-182

Impedance % @ 170 °C 5.75

End. Type/Category Type ou catégorie de boîtier 3R C

Weight Poids _____

LR 3902

DISTRIBUTION TRANSFORMER E147879 ALSO VERIFIED IN ACCORDANCE TO ENERGY STANDARD CB02.2-12

LISTED

SPACINGS BETWEEN ANY VENTILATED ENCLOSURE PANEL AND ANY ADJACENT WALL SHALL BE A MINIMUM OF 8.25 INCHES
ESPACEMENTS ENTRE LES PANNEAUX DE BOÎTIER VENTILÉ ET LES MURS ADJACENT DOIVENT ÊTRE UN MINIMUM DE 8.25 POUNCES
SEISMIC QUALIFICATIONS, FLOOR MOUNT ONLY
QUALIFICATIONS SISMOES, MONTAGE AU SOL SEULEMENT
OSP-0136-10 IBC 2012/ASCE 7-10
SDS<=2.0G Z/H=1 IP=1.5

VOLTS	CURRENT COURANT	% RATED VOLTAGE NOMINALE	CONNECTION CONNECTION PAR PHASE
4368	99.1	105	1-2
4264	101.6	102.5	2-3
4160	104.1	100	3-4
4056	106.8	97.5	4-5
3952	109.6	95	5-6



TITLE:		3PH DISTRIBUTION TRANSFORMER NAMEPLATE INFORMATION	
4	21/11/25	CS	NPL IMPEDANCE AND WEIGHT UPDATE
3	21/07/16	PP	EDB UPDATE
NO.	DATE	BY	REVISION
DES:		ASETH	
DATE:		15/12/11	
SCALE:		NTS	

SHEET 1 OF 3

EDBMG3A0750SKSCHCO

4.0 httpd 2026/06/03 18:29

THIS DRAWING CONTAINS STRICTLY CONFIDENTIAL INFORMATION BELONGING TO HAMMOND POWER SOLUTIONS AND MUST NOT BE DISTRIBUTED OUTSIDE AUTHORIZED PARTIES.

FRONT VIEW

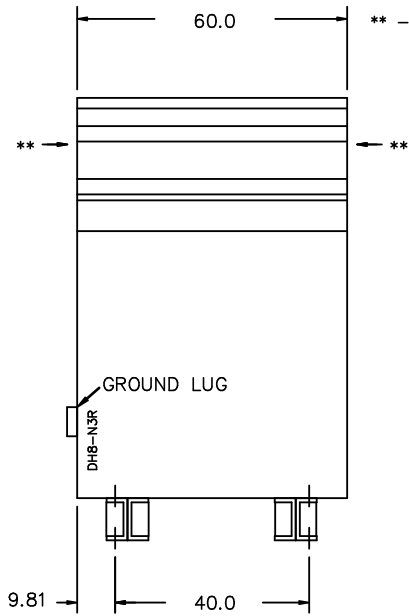

** - Recommended cable entry locations only
cutouts & gland plates not provided.

SIDE VIEW

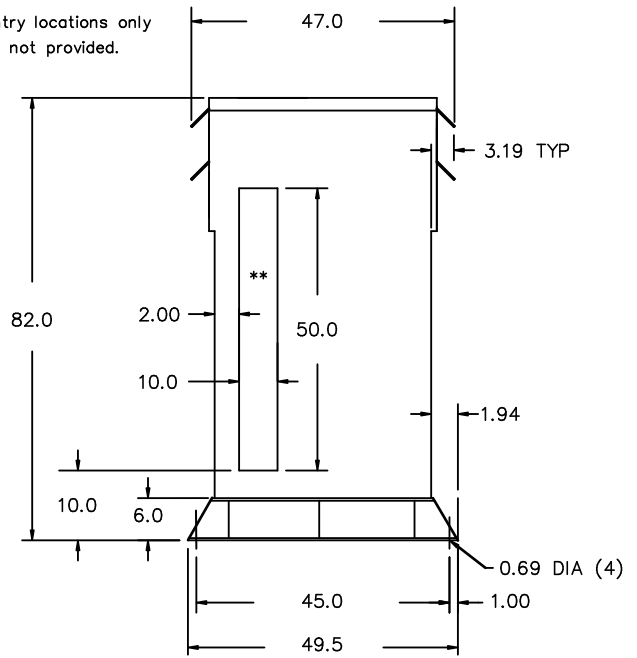

All Dimensions in inches

ENCLOSURE COLOR : ANSI 61 GREY - OUTDOOR

H.V.1. TERMINAL DETAIL

L.V.1. TERMINAL DETAIL

MECHANICAL TYPE LUGS INCLUDED
SUITABLE FOR 250MCM-6 CU/AL
CONDUCTORS
1 CONDUCTOR PER PHASE

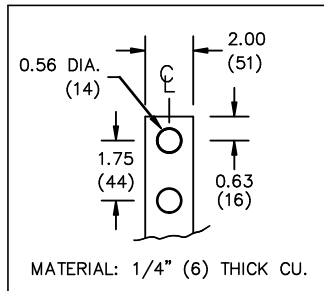

CUSTOMER NOTES:

- HV1 TERMINATED AT TOP FRONT
- LV1 TERMINATED AT BOTTOM FRONT



TITLE: 3PH DISTRIBUTION TRANSFORMER
MECHANICAL INFORMATION

4	21/11/25	CS	NPL IMPEDANCE AND WEIGHT UPDATE	DES: ASETH
3	21/07/16	PP	EDB UPDATE	DATE: 15/12/11
NO.	DATE	BY	REVISION	SCALE: NTS

SHEET 2 OF 3

EDBMC3A0750SKSCHCO

ENCLOSURE BOTTOM VIEW

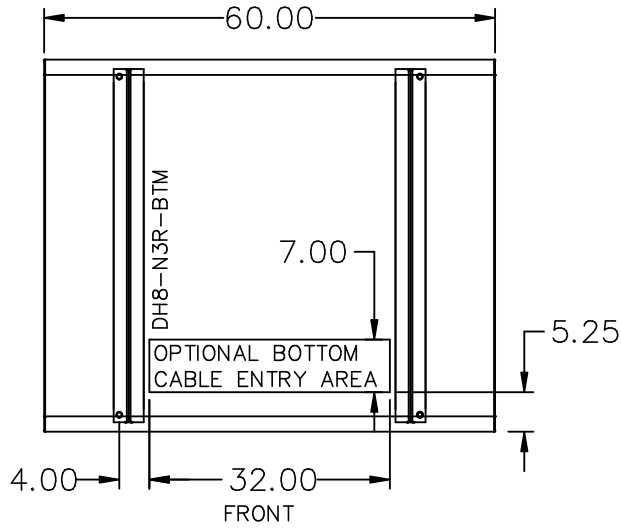

NOTE:
 WHEN BOTTOM CABLE ENTRY IS OPTED, THE SPACE USED FOR CONDUITS IN THE FRONT OF THE TRANSFORMER SHOULD NOT OBSTRUCT MORE THAN 50% OF THE FRONT AIR INTAKE AREA DEFINED BETWEEN THE BOTTOM PLATE AND THE SUPPORTING LEGS.
 SEE MANUAL FOR ADDITIONAL INFORMATION



TITLE: 3PH DISTRIBUTION TRANSFORMER
 ENCLOSURE BOTTOM VIEW

4	21/11/25	CS	NPL IMPEDANCE AND WEIGHT UPDATE	DES: ASETH
3	21/07/16	PP	EDB UPDATE	DATE: 15/12/11
NO.	DATE	BY	REVISION	SCALE: NTS

SHEET 3 OF 3

EDBMC3A0750SKSCHCO