

- IMPEDANCE SHOWN IS CALCULATED VALUE

d000590hb

hammond Distribution Transformer
POWER SOLUTIONS Transformateur de Distribution



8 03423 13286 6
 ALSO VERIFIED IN ACCORDANCE
 TO ENERGY STANDARD C802.2-18
 BY UNDERWRITERS LABORATORIES INC. 316

LISTED

Baraboo, WI
 Monterrey, MX
 Part No. MG3A0500SKSAHCO

SPACINGS BETWEEN ANY VENTILATED ENCLOSURE PANEL AND
 ANY ADJACENT WALL SHALL BE A MINIMUM OF 12 INCHES
 ESPACEMENTS ENTRE LES PANNÉAUX DE BOÎTIER
 VENTILÉ ET LES MURS ADJACENT DOIVENT ÊTRE
 UN MINIMUM DE 12 POUNCES

SEISMIC QUALIFICATIONS, FLOOR MOUNT ONLY
 QUALIFICATIONS SISMOES, MONTAGE AU SOL SEULEMENT
 OSP-0136-10 IBC 2012/ASCE 7-10
 SDS<=2.0G Z/H=1 IP=1.5

VOLTS	CURRENT COURANT	% RATED VOLTAGE % NOMINALE	CONNECTION TYPE CONNEXION PAR PHASE
4368	66.1	105	1-2
4264	67.7	102.5	2-3
4160	69.4	100	3-4
4056	71.2	97.5	4-5
3952	73.0	95	5-6

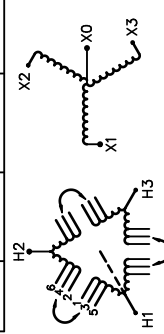

Cust. Ref. Ref. du Client	Serial No. No. de Serie		
Phase	HV/HT	4160V	69.4A
Type	BIL	30 kV	
Cooling Refroidissement	Term Bornes	H1 H2 H3	
kVA	LV/BT	480Y/277V	601.4A
Temp. Rise Echauffement	BIL	10 kV	
Temp Class Classe Temp	Term Bornes	X0 X1 X2 X3	
Winding Enroulement	Energy Regulations	DOE 10 CFR PART 431:2016	
Frequency Frequence Hz	Reglements de Energetique	CEE ACT SOR/2018-201	
Impedance % @ 170°C			
End. Type/Category Type ou categorie de boîtier		3R	C
Weight Poids			3000



TITLE: 3PH DISTRIBUTION TRANSFORMER NAMEPLATE INFORMATION			
NO.	DATE	BY	REVISION
4	21/07/16	PP	EDB UPDATE
3	20/03/17	PP	SEISMIC UPDATE
			DES: ASETH
			DATE: 15/10/05
			SCALE: NTS

SHEET 1 OF 3
 EDBMG3A0500SKSAHCO
 4.1 http://www.hammond.com 2026/06/06 21:16

THIS DRAWING CONTAINS STRICTLY CONFIDENTIAL INFORMATION BELONGING TO HAMMOND POWER SOLUTIONS AND MUST NOT BE DISTRIBUTED OUTSIDE AUTHORIZED PARTIES.

FRONT VIEW

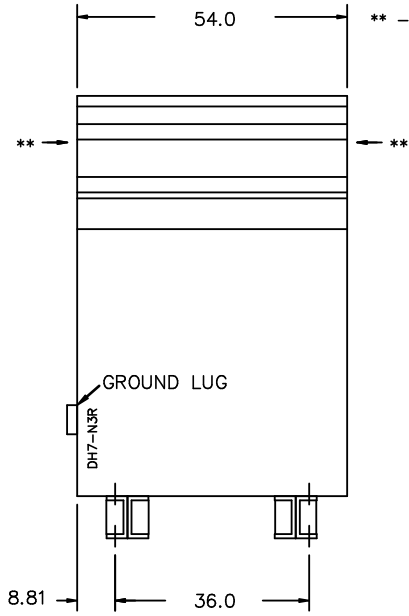

** - Recommended cable entry locations only
cutouts & gland plates not provided.

SIDE VIEW

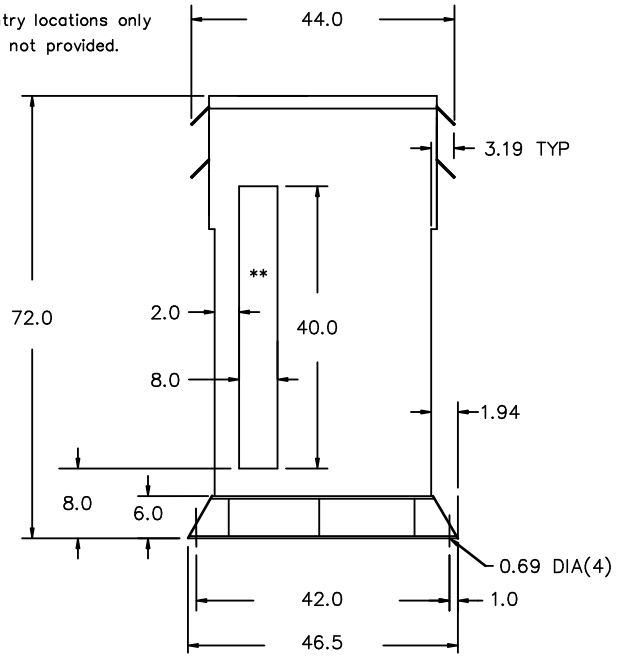

All Dimensions in inches

ENCLOSURE COLOR : ANSI 61 GREY - OUTDOOR

H.V.1. TERMINAL DETAIL

L.V.1. TERMINAL DETAIL

MECHANICAL TYPE LUGS INCLUDED
SUITABLE FOR #2/0-14 CU/AL
CONDUCTORS
1 CONDUCTOR PER PHASE

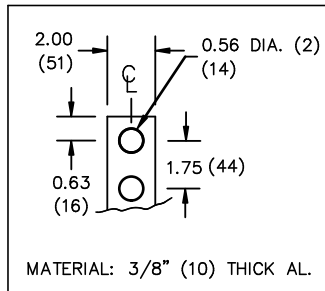

CUSTOMER NOTES:

- HV1 TERMINATED AT TOP FRONT
- LV1 TERMINATED AT BOTTOM FRONT



TITLE: 3PH DISTRIBUTION TRANSFORMER
MECHANICAL INFORMATION

4	21/07/16	PP	EDB UPDATE	DES: ASETH
3	20/03/17	PP	SEISMIC UPDATE	DATE: 15/10/05
NO.	DATE	BY	REVISION	SCALE: NTS

SHEET 2 OF 3

EDBMC3A0500SKSAHCO

ENCLOSURE BOTTOM VIEW



NOTE:
 WHEN BOTTOM CABLE ENTRY IS OPTED, THE SPACE USED FOR CONDUITS IN THE FRONT OF THE TRANSFORMER SHOULD NOT OBSTRUCT MORE THAN 50% OF THE FRONT AIR INTAKE AREA DEFINED BETWEEN THE BOTTOM PLATE AND THE SUPPORTING LEGS.
 SEE MANUAL FOR ADDITIONAL INFORMATION



TITLE: 3PH DISTRIBUTION TRANSFORMER
 ENCLOSURE BOTTOM VIEW

4	21/07/16	PP	EDB UPDATE	DES: ASETH
3	20/03/17	PP	SEISMIC UPDATE	DATE: 15/10/05
NO.	DATE	BY	REVISION	SCALE: NTS

SHEET 3 OF 3

EDBMC3A0500SKSAHCO