



TITLE: 3PH DISTRIBUTION TRANSFORMER
NAMEPLATE INFORMATION

3	21/07/16	PP	EDB UPDATE	DES: RBHATIA
2	20/03/17	PP	SEISMIC UPDATE	DATE: 16/10/07
NO.	DATE	BY	REVISION	SCALE: NTS

SHEET 1 OF 3

EDBMG3A0500RKS/AHCO

3.1 httpd 2026/04/24 11:21

THIS DRAWING CONTAINS STRICTLY CONFIDENTIAL INFORMATION BELONGING TO HAMMOND POWER SOLUTIONS AND MUST NOT BE DISTRIBUTED OUTSIDE AUTHORIZED PARTIES.

hammond
POWER SOLUTIONS

Distribution Transformer
Transformateur de Distribution

LR 3902
DISTRIBUTION TRANSFORMER
E147879

8 03423 13371 9

ALSO VERIFIED IN ACCORDANCE TO ENERGY STANDARD C802.2-18 BY UNDERWITERS LABORATORIES INC. 316

LISTED

Hyderabad, IN Guelph, ONT Baraboo, WI Monterrey, MX Part No. MG3A0500RKS/AHCO

Cust. Ref.	Serial No.	HV/HT	2400V	VOLTS	CONNECTION FOR CONNECTION PER PHASE
Ref. du Client	No. de Serie	HV/HT	2400V		
Phase	3	BIL	20 kV		1-2 2-3 3-4 4-5 5-6
Type	K	Term Bornes	H1 H2 H3		
Cooling Refroidissement	ANN	LV/BT	480Y/277V		
kVA	500	BIL	10 kV		
Temp. Rise Echauffement	150 °C	Term Bornes	X0 X1 X2 X3		
Temp Class	220 °C	Winding Enroulement	AL		
Frequency	60	Energy Regulations	DOE 10 CFR PART 431:2016		
Impedance % @ 170 °C	5.9	Reglements de Energetique	CEE ACT SOR/2018-201		
End. Type/Category Type ou categorie de boitier	3R C	Weight Poids	2900		

CURRENT COURANT	% RATED VOLTAGE % NOMINALE	CONNECTION FOR CONNECTION PER PHASE
115 117 120 123 127	105 102.5 100 97.5 95	1-2 2-3 3-4 4-5 5-6

SEISMIC QUALIFICATIONS:
AS FLOOR MOUNT ONLY
IBC 2018/ASCE 7-16
SDS<=2.0g Z/n=0 Ip=1.5

SPACINGS BETWEEN ANY VENTILATED ENCLOSURE PANEL AND ANY ADJACENT WALL SHALL BE A MINIMUM OF 12 INCHES

d000590hb

FRONT VIEW

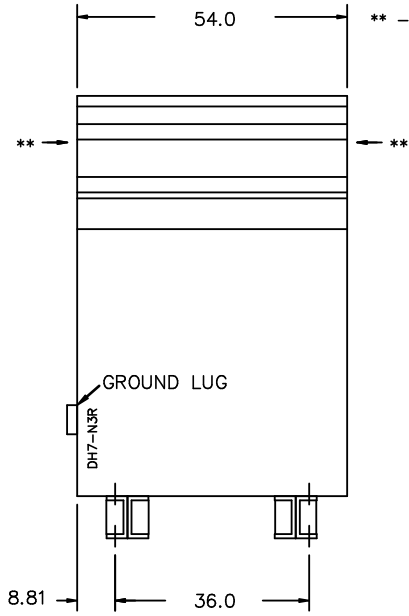

** - Recommended cable entry locations only
cutouts & gland plates not provided.

SIDE VIEW

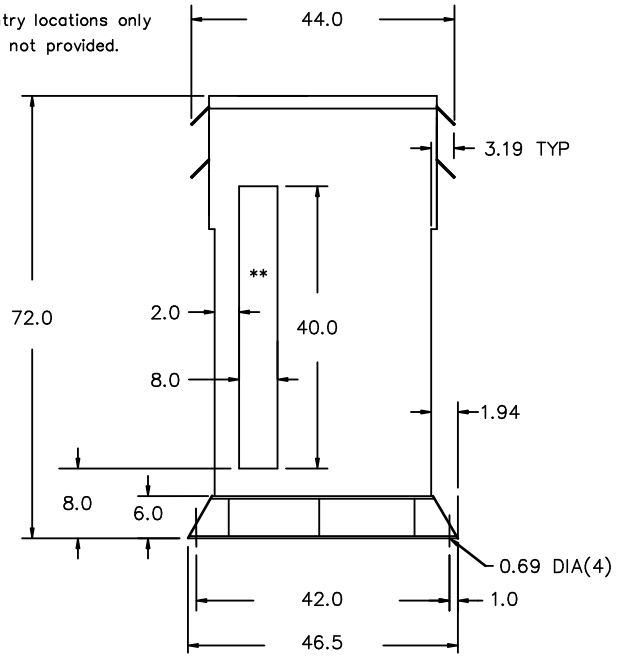

All Dimensions in inches

ENCLOSURE COLOR : ANSI 61 GREY - OUTDOOR

H.V.1. TERMINAL DETAIL

L.V.1. TERMINAL DETAIL

MECHANICAL TYPE LUGS INCLUDED
SUITABLE FOR 250MCM-6 CU/AL
CONDUCTORS
1 CONDUCTOR PER PHASE

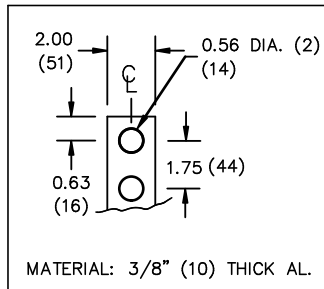

CUSTOMER NOTES:

- HV1 TERMINATED AT TOP FRONT
- LV1 TERMINATED AT BOTTOM FRONT

THIS DRAWING CONTAINS STRICTLY CONFIDENTIAL INFORMATION BELONGING TO HAMMOND POWER SOLUTIONS AND MUST NOT BE DISTRIBUTED OUTSIDE AUTHORIZED PARTIES.



TITLE: 3PH DISTRIBUTION TRANSFORMER

3	21/07/16	PP	EDB UPDATE	DES: RBHATIA
2	20/03/17	PP	SEISMIC UPDATE	DATE: 16/10/07
NO.	DATE	BY	REVISION	SCALE: NTS

SHEET 2 OF 3

EDBMC3A0500RKS/SH/CO

3.1 httpd 2026/04/24 11:21

ENCLOSURE BOTTOM VIEW



NOTE:
 WHEN BOTTOM CABLE ENTRY IS OPTED, THE SPACE USED FOR CONDUITS IN THE FRONT OF THE TRANSFORMER SHOULD NOT OBSTRUCT MORE THAN 50% OF THE FRONT AIR INTAKE AREA DEFINED BETWEEN THE BOTTOM PLATE AND THE SUPPORTING LEGS.
 SEE MANUAL FOR ADDITIONAL INFORMATION



TITLE: 3PH DISTRIBUTION TRANSFORMER
ENCLOSURE BOTTOM VIEW

3	21/07/16	PP	EDB UPDATE	DES: RBHATIA
2	20/03/17	PP	SEISMIC UPDATE	DATE: 16/10/07
NO.	DATE	BY	REVISION	SCALE: NTS

SHEET 3 OF 3

EDBMC3A0500RKSAMCO