



TITLE: 3PH DISTRIBUTION TRANSFORMER  
NAMEPLATE INFORMATION

NO.	DATE	BY	REVISION	DES:	RMOVVA
2	21/07/16	PP	EDB UPDATE	DATE:	17/11/14
1	20/03/17	PP	SEISMIC UPDATE	SCALE:	NTS

SHEET 1 OF 3

EDBMG3A0300SKSCHCO

2.0 http://2026/04/05 03:12

THIS DRAWING CONTAINS STRICTLY CONFIDENTIAL INFORMATION BELONGING TO HAMMOND POWER SOLUTIONS AND MUST NOT BE DISTRIBUTED OUTSIDE AUTHORIZED PARTIES.

**hammond**  
POWER SOLUTIONS

Distribution Transformer  
Transformateur de Distribution

Baraboo, WI  
Monterrey, MX

Hyderabad, IN    Guelph, ONT    Compton, CA

Part No. MG3A0300SKSCHCO

LR 3902  
DISTRIBUTION TRANSFORMER  
E147879

Serial No. [ ]  
HV/HT 4160V  
BIL 30 kV  
Term Bornes H1 H2 H3  
LV/BT 480Y/277V, 360.8A  
BIL 10 kV  
Term Bornes X0 X1 X2 X3  
DOE 10 CFR PART 431:2016

CONNECTION DIAGRAM FOR CONNECTION PER PHASE

VOLTS	CURRENT COURANT	% RATED VOLTAGE / % NOMINALE	CONNECTION PER PHASE
4368	39.7	105	1-2
4264	40.6	102.5	2-3
4160	41.6	100	3-4
4056	42.7	97.5	4-5
3952	43.8	95	5-6

SPACINGS BETWEEN ANY VENTILATED ENCLOSURE PANEL AND ANY ADJACENT WALL SHALL BE A MINIMUM OF 5 INCHES EXCEPT WHEN WALL MOUNTED USING APPROVED WALL MOUNT!!

SEISMIC QUALIFICATIONS, OSP-0136-10  
IBC 2012/ASCE 7-10  
SDS<=2.0G Z/H=1 IP=1.5  
FLOOR MOUNT ONLY

Cust. Ref. [ ]    Ref. du Client [ ]

Phase 3

Type K

Cooling Refroidissement ANN

kVA 300

Temp. Rise Echauffement 150 °C

Temp Class Classe Temp 220 °C

Winding Enroulement CU

Frequency Fréquence Hz 60

Impedance % @ 170 °C 3.6

End. Type/Category Type ou catégorie de boîtier 3R C

Weight Poids lbs 2400

Also verified in accordance to ENERGY STANDARD C802.2-12 BY UNDERWRITERS LABORATORIES, INC. 33416

d000590hb

FRONT VIEW

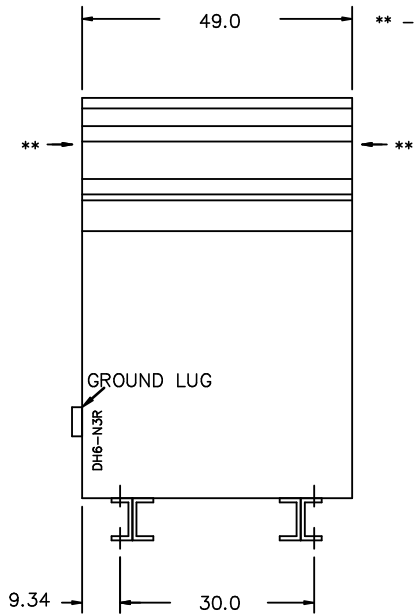

SIDE VIEW

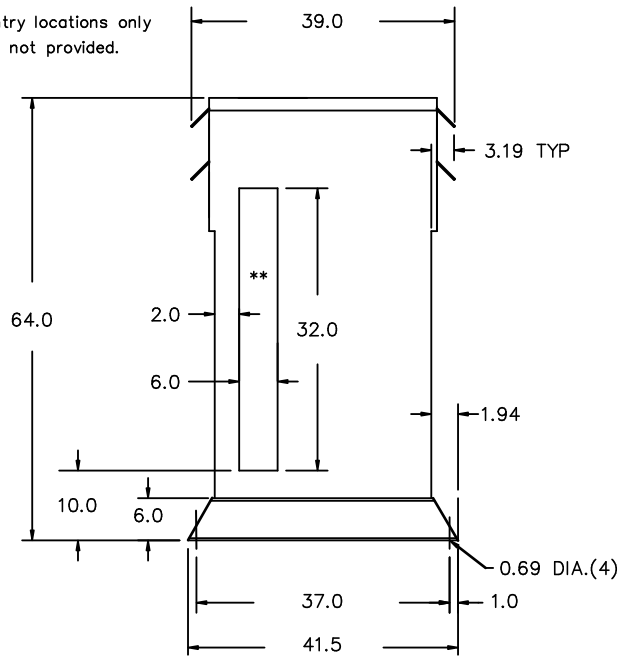

All Dimensions in inches

ENCLOSURE COLOR : ANSI 61 GREY - OUTDOOR

H.V.1. TERMINAL DETAIL

L.V.1. TERMINAL DETAIL

MECHANICAL TYPE LUGS INCLUDED  
SUITABLE FOR #14-2 CU/AL  
CONDUCTORS  
1 CONDUCTOR PER PHASE

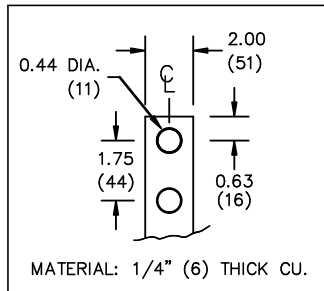

CUSTOMER NOTES:

- HV1 TERMINATED AT TOP FRONT
- LV1 TERMINATED AT BOTTOM FRONT



TITLE: 3PH DISTRIBUTION TRANSFORMER

2	21/07/16	PP	EDB UPDATE	DES: RMOVVA
1	20/03/17	PP	SEISMIC UPDATE	DATE: 17/11/14
NO.	DATE	BY	REVISION	SCALE: NTS

SHEET 2 OF 3

EDBMC3A0300SKSCHCO

ENCLOSURE BOTTOM VIEW



NOTE:  
 WHEN BOTTOM CABLE ENTRY IS OPTED, THE SPACE USED FOR CONDUITS IN THE FRONT OF THE TRANSFORMER SHOULD NOT OBSTRUCT MORE THAN 50% OF THE FRONT AIR INTAKE AREA DEFINED BETWEEN THE BOTTOM PLATE AND THE SUPPORTING LEGS.  
 SEE MANUAL FOR ADDITIONAL INFORMATION



TITLE: 3PH DISTRIBUTION TRANSFORMER  
 ENCLOSURE BOTTOM VIEW

2	21/07/16	PP	EDB UPDATE	DES: RMOVVA
1	20/03/17	PP	SEISMIC UPDATE	DATE: 17/11/14
NO.	DATE	BY	REVISION	SCALE: NTS

SHEET 3 OF 3

EDBMC3A0300SKSCHCO