



TITLE: 3PH DISTRIBUTION TRANSFORMER
NAMEPLATE INFORMATION

1	21/07/16	PP	EDB UPDATE	DES: DCORTEZ
NO.	DATE	BY	REVISION	SCALE: NTS

SHEET 1 OF 3

EDBMG3A0300RBSCHCO

1.0 httpd 2026/04/03 14:29

THIS DRAWING CONTAINS STRICTLY CONFIDENTIAL INFORMATION BELONGING TO HAMMOND POWER SOLUTIONS AND MUST NOT BE DISTRIBUTED OUTSIDE AUTHORIZED PARTIES.

hammond
POWER SOLUTIONS

Distribution Transformer
Transformateur de Distribution

Part No. MG3A0300RBSCHCO

LR 3902
DISTRIBUTION TRANSFORMER
E147879

LISTED

Guelph, ONT Compton, CA Baraboo, WI Monterrey, MX

Cust. Ref. [] Serial No. []
Ref. du Client [] No. de Serie []

Phase	3	HV/HT	2400V	72.2A
Type	K	BIL	20 kV	
Cooling Refroidissement	ANN	Term Bornes	H1 H2 H3	
kVA	300	LV/BT	208Y/120V	833A
Temp. Rise Echauffement	150 °C	BIL	10 kV	
Temp Class Classe Temp	220 °C	Term Bornes	X0 X1 X2 X3	
Winding Enroulement	CU	Energy Regulations Règlements de l'énergie	DOE 10 CFR PART 431:2016	
Frequency Fréquence Hz	60	CEE ACT SOR/2018-201		
Impedance % @ 170 °C	5			
End. Type/Category Type ou catégorie de boîtier	3R			
Weight Poids	2200			

Hyderabad, IN Compton, CA Baraboo, WI Monterrey, MX Part No. MG3A0300RBSCHCO

Also verified in accordance to Energy Standard C802.2-18 by Underwriters Laboratories Inc. © 306

SPACINGS BETWEEN ANY VENTILATED ENCLOSURE PANEL AND ANY ADJACENT WALL SHALL BE A MINIMUM OF 5 INCHES EXCEPT WHEN WALL MOUNTED USING APPROVED WALL MOUNT

VOLTS	CURRENT COURANT	% RATED VOLTAGE % NOMINALE	CONNECTION FOR CONNECTION PAR PHASE
2520	68.7	105	1-2
2460	70.4	102.5	2-3
2400	72.2	100	3-4
2340	74.0	97.5	4-5
2280	76.0	95	5-6

SEISMIC QUALIFICATIONS:
AS FLOOR MOUNT ONLY
IBC 2018/ASCE 7-16
SDS<=2.0g Z/n=0 Ip=1.5

d000590hb

FRONT VIEW

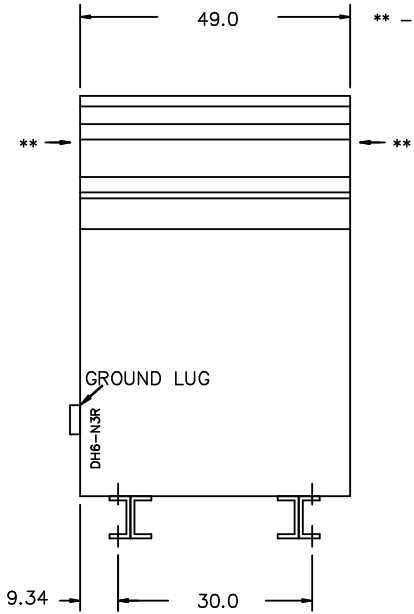

** - Recommended cable entry locations only
cutouts & gland plates not provided.

SIDE VIEW



All Dimensions in inches

ENCLOSURE COLOR : ANSI 61 GREY - OUTDOOR

HV TERMINAL DETAIL

LV TERMINAL DETAIL

MECHANICAL TYPE LUGS INCLUDED
SUITABLE FOR #2/0-14 CU/AL
CONDUCTORS
1 CONDUCTOR PER PHASE

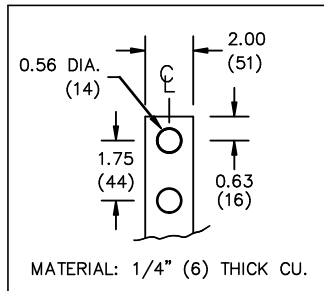

CUSTOMER NOTES:

- HV TERMINATED AT TOP FRONT
- LV TERMINATED AT BOTTOM FRONT

THIS DRAWING CONTAINS STRICTLY CONFIDENTIAL INFORMATION BELONGING TO HAMMOND POWER SOLUTIONS AND MUST NOT BE DISTRIBUTED OUTSIDE AUTHORIZED PARTIES.



TITLE: 3PH DISTRIBUTION TRANSFORMER

1	21/07/16	PP	EDB UPDATE	DES: DCORTEZ
NO.	DATE	BY	REVISION	SCALE: NTS

SHEET 2 OF 3

EDBMC3A0300RBSCHCO

1.0 httpd 2026/04/03 14:29

ENCLOSURE BOTTOM VIEW



NOTE:
 WHEN BOTTOM CABLE ENTRY IS OPTED, THE SPACE USED FOR CONDUITS IN THE FRONT OF THE TRANSFORMER SHOULD NOT OBSTRUCT MORE THAN 50% OF THE FRONT AIR INTAKE AREA DEFINED BETWEEN THE BOTTOM PLATE AND THE SUPPORTING LEGS.
 SEE MANUAL FOR ADDITIONAL INFORMATION



TITLE: 3PH DISTRIBUTION TRANSFORMER
 ENCLOSURE BOTTOM VIEW

1	21/07/16	PP	EDB UPDATE	DES: DCORTEZ
NO.	DATE	BY	REVISION	SCALE: NTS

SHEET 3 OF 3

EDBMC3A0300RBSCHCO