



TITLE: 3PH DISTRIBUTION TRANSFORMER
NAMEPLATE INFORMATION

NO.	DATE	BY	REVISION
2	21/07/16	PP	EDB UPDATE
1	20/03/17	PP	SEISMIC UPDATE
			DES: CSHAH
			DATE: 20/02/20
			SCALE: NTS

SHEET 1 OF 3

EDBMG3A0150SBSGCCO

2.1 httpd 2026/04/28 11:06

THIS DRAWING CONTAINS STRICTLY CONFIDENTIAL INFORMATION BELONGING TO HAMMOND POWER SOLUTIONS AND MUST NOT BE DISTRIBUTED OUTSIDE AUTHORIZED PARTIES.

hammond
POWER SOLUTIONS

Distribution Transformer
Transformateur de Distribution

LR 3902
DISTRIBUTION TRANSFORMER
E147879

LISTED

Hyderabad, IN Guelph, ONT Baraboo, WI 03423 13440 2
Compton, CA Monterrey, MX Part No. MG3A0150SBSGCCO

Cust. Ref.	Serial No.	HV/HT	4160V	20.8A	CONNECTION FOR CONNECTION PER PHASE
Ref. du Client	No. de Serie	HV/HT	4160V	20.8A	1-2 2-3 3-4 4-5 5-6
Phase	3	BIL	30 kV	19.8	% RATED VOLTAGE / % NOMINALE
Type	K	Term Bornes	H1 H2 H3	20.3	CURRENT COURANT
Cooling Refroidissement	ANN	LV/BT	208Y/120V	20.8	4264
kVA	150	BIL	10 kV	21.4	100
Temp. Rise Echauffement	130 °C	Term Bornes	X0 X1 X2 X3	21.9	97.5
Temp Class Classe Temp	220 °C	Energy Regulations Règlement de Energetique	DOE 10 CFR PART 431:2016		95
Winding Enroulement	CU	Frequency	60		
Frequency	60	Impedance % @ 150 °C	3.4		
End. Type/Category Type ou catégorie de boîtier	3R	Weight lbs/kg Poids	1200/545		

SPACINGS BETWEEN ANY VENTILATED ENCLOSURE PANEL AND ANY ADJACENT WALL SHALL BE A MINIMUM OF 5 INCHES EXCEPT WHEN WALL MOUNTED USING APPROVED WALL MOUNT

SEISMIC QUALIFICATIONS:
AS FLOOR MOUNT ONLY
IBC 2018/ASCE 7-16
SDS<=2.0g Z/n=1 Ip=1.5

d000590hb

THIS DRAWING CONTAINS STRICTLY CONFIDENTIAL INFORMATION BELONGING TO HAMMOND POWER SOLUTIONS AND MUST NOT BE DISTRIBUTED OUTSIDE AUTHORIZED PARTIES.



All Dimensions in inches

ENCLOSURE COLOR :ANSI 61 GREY – OUTDOOR

HV TERMINAL DETAIL

LV TERMINAL DETAIL

MECHANICAL TYPE LUGS INCLUDED
SUITABLE FOR #14-2 CU/AL
CONDUCTORS
1 CONDUCTOR PER PHASE

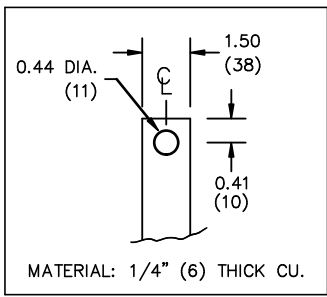

CUSTOMER NOTES:

- HV TERMINATED AT TOP FRONT
- LV TERMINATED AT BOTTOM FRONT



TITLE: 3PH DISTRIBUTION TRANSFORMER

NO.	DATE	BY	REVISION	SCALE:
2	21/07/16	PP	EDB UPDATE	DES: CSHAH
1	20/03/17	PP	SEISMIC UPDATE	DATE: 20/02/20
				SCALE: NTS

SHEET 2 OF 3

EDBMC3A0150SBSG000

2.1 httpd 2026/04/28 11:06

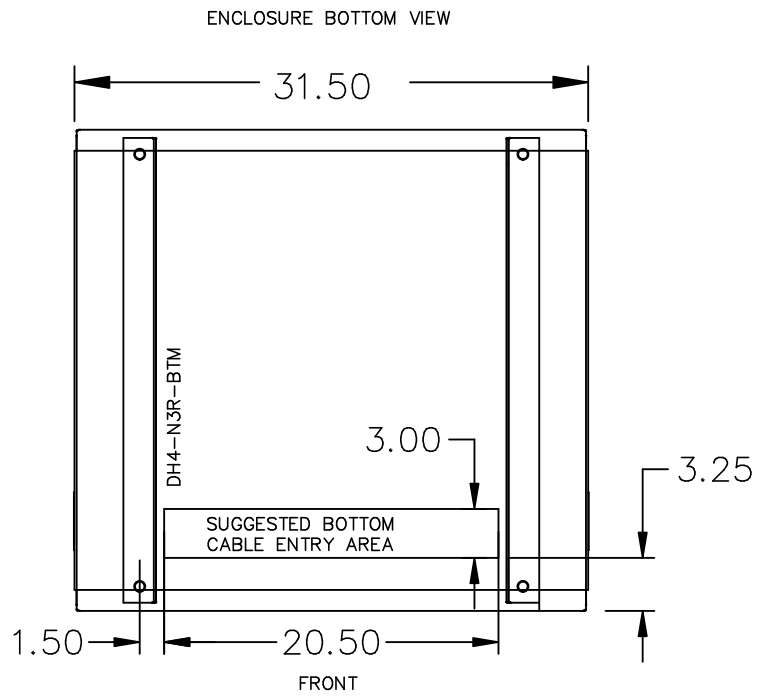

NOTE:
 WHEN BOTTOM CABLE ENTRY IS OPTED, THE SPACE USED FOR CONDUITS IN THE FRONT OF THE TRANSFORMER SHOULD NOT OBSTRUCT MORE THAN 50% OF THE FRONT AIR INTAKE AREA DEFINED BETWEEN THE BOTTOM PLATE AND THE SUPPORTING LEGS.
 SEE MANUAL FOR ADDITIONAL INFORMATION



TITLE: 3PH DISTRIBUTION TRANSFORMER
 ENCLOSURE BOTTOM VIEW

2	21/07/16	PP	EDB UPDATE	DES: CSHAH
1	20/03/17	PP	SEISMIC UPDATE	DATE: 20/02/20
NO.	DATE	BY	REVISION	SCALE: NTS

SHEET 3 OF 3

EDBMC3A0150SRSC00