



TITLE: 1PH DISTRIBUTION TRANSFORMER  
NAMEPLATE INFORMATION

|     |      |    |          |
|-----|------|----|----------|
| NO. | DATE | BY | REVISION |
|     |      |    |          |

|        |          |
|--------|----------|
| DES:   | DCORTEZ  |
| DATE:  | 23/05/31 |
| SCALE: | NTS      |

SHEET 1 OF 2

EDBMG2L0075SESCHCO

0.1 httpd 2026/05/22 12:55

THIS DRAWING CONTAINS STRICTLY CONFIDENTIAL INFORMATION BELONGING TO HAMMOND POWER SOLUTIONS AND MUST NOT BE DISTRIBUTED OUTSIDE AUTHORIZED PARTIES.

**hammond**  
POWER SOLUTIONS

Distribution Transformer  
Transformateur de Distribution

LR 3902  
DISTRIBUTION TRANSFORMER  
E147879

Hyderabad, IN    Guelph, ONT    Baraboo, WI  
Compton, CA    Monterrey, MX

Part No. MG2L0075SESCHCO

8 03423 13344 3

ALSO VERIFIED IN ACCORDANCE TO ENERGY STANDARD C802.2-18 BY UNDERWRIERS LABORATORIES INC. 3166

**LISTED**

SPACINGS BETWEEN ANY VENTILATED ENCLOSURE PANEL AND ANY ADJACENT WALL SHALL BE A MINIMUM OF 5 INCHES

d000590hb

| VOLTS | CURRENT COURANT | % RATED VOLTAGE % NOMINALE | CONNECTION CONNECTION PAR PHASE | SECONDARY VOLTS<br>120V LINK X4-X2 & X3-X1<br>240V LINK X2-X3 |
|-------|-----------------|----------------------------|---------------------------------|---|
| 4368  | 17.2            | 105                        | 1-2                             |   |
| 4264  | 17.6            | 102.5                      | 2-3                             |   |
| 4160  | 18.0            | 100                        | 3-4                             |   |
| 4056  | 18.5            | 97.5                       | 4-5                             |   |
| 3952  | 19.0            | 95                         | 5-6                             |   |

|   |                          |
|---|--------------------------|
| Serial No. No. de Serie                         |                          |
| HV/HT   | 4160V                    |
| BIL   | 18.0A                    |
| Term Bornes                                     | 30 kV                    |
| LV/BT   | H1 H2                    |
|   | 120/240V 625/312A        |
| BIL   | 10 kV                    |
| Term Bornes                                     | X4 X2 X3 X1              |
| Energy Regulations Reglements Energetique       | DOE 10 CFR PART 431:2016 |
| Frequency                                       | 60                       |
| Impedance % @ 170°C                             | 3.8                      |
| End. Type/Category Type ou categorie de boitier | 3R C                     |
| Weight lbs/kg Poids                             | 727/330                  |

THIS DRAWING CONTAINS STRICTLY CONFIDENTIAL INFORMATION BELONGING TO HAMMOND POWER SOLUTIONS AND MUST NOT BE DISTRIBUTED OUTSIDE AUTHORIZED PARTIES.



All Dimensions in inches



ENCLOSURE COLOR :ANSI 61 GREY- OUTDOOR

HV TERMINAL DETAIL

LV TERMINAL DETAIL

MECHANICAL TYPE LUGS INCLUDED  
SUITABLE FOR #14-2 CU/AL  
CONDUCTORS  
1 CONDUCTOR PER PHASE

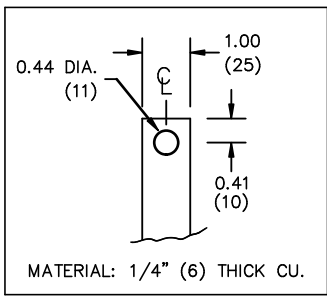

CUSTOMER NOTES:

- HV TERMINATED AT TOP FRONT
- LV TERMINATED AT BOTTOM FRONT



TITLE: 1PH DISTRIBUTION TRANSFORMER

|     |      |    |          |                |
|-----|------|----|----------|----------------|
|     |      |    |          | DES: DCORTEZ   |
|     |      |    |          | DATE: 23/05/31 |
| NO. | DATE | BY | REVISION | SCALE: NTS     |

SHEET 2 OF 2

EDBMG210075ESCHCO

0.1 httpd 2026/05/22 12:55