



® LR 3902

UL DRY TYPE TRANSFORMER 774US E112313

LISTED

GUELPH, ONT. BARABOO, WI COMPTON, CA MONTERREY, MX

THREE PHASE DRY TYPE DRIVE ISOLATION TRANSFORMER
 TRANSFORMATEUR TRIPHASE POUR VARIATEUR DE VITESSE DE MOTEURS

HV/HT	575V				Cust. Ref. Réf. du client	
BIL	-				Serial No. No. de série	
TERM. BORNES	H1 H2 H3				Part No. No. de pièce	DM660NJ
	VOLTS	CURRENT COURANT	% RATED VOLTAGE % TENSION NOMINALE	CONNECTION EACH PHASE CONNEXION PAR PHASE	kVA	660
	604	631	105	1-2	TYPE	K
	589	647	102.5	2-3	Cooling Refroidissement	ANN
	575	663	100	3-4	Temp. Rise Echauffement	150 °C
	561	680	97.5	4-5	Temp. Class Classe de Temp.	220 °C
	546	698	95	5-6	Frequency Fréquence	60 Hz
	460Y/266V				Impédance % @ 170 °C	6
LV/BT	-				Encl. Type Type de boîtier	3R
BIL	-				Wt Poids	3300 lbs
TERM. BORNES	X0 X1 X2 X3				Winding Enroulement	AL

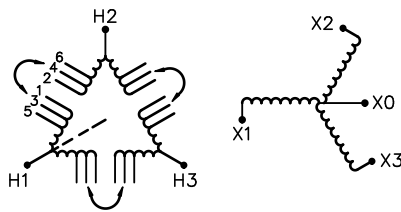

SPACINGS BETWEEN ANY VENTILATED ENCLOSURE PANEL AND ANY ADJACENT WALL SHALL BE A MINIMUM OF 12 INCHES

d003102b



TITLE: 3PH DRIVE TRANSFORMER
 NAMEPLATE INFORMATION

2	21/07/13	PP	EDB UPDATE	DES: GPATEL
1	15/09/09	JF	UPDATED TO MEET NEW STDS [HCN 61037]	DATE: 10/12/28
NO.	DATE	BY	REVISION	SCALE: NTS

SHEET 1 OF 2

EDBDM660NJ

2.0 httpd 2026/04/02 02:43 THIS DRAWING CONTAINS STRICTLY CONFIDENTIAL INFORMATION BELONGING TO HAMMOND POWER SOLUTIONS AND MUST NOT BE DISTRIBUTED OUTSIDE AUTHORIZED PARTIES.

FRONT VIEW

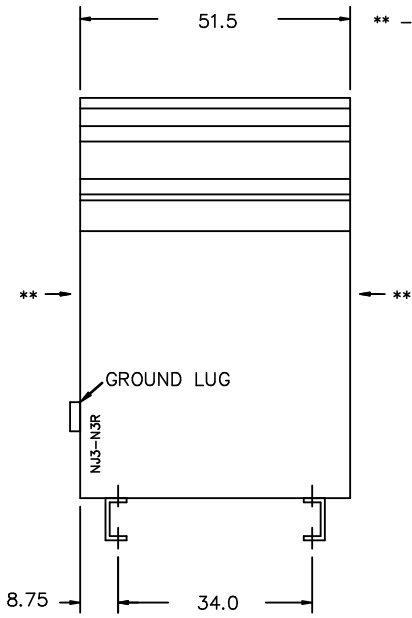

** - Recommended cable entry locations only
cutouts & gland plates not provided.

SIDE VIEW

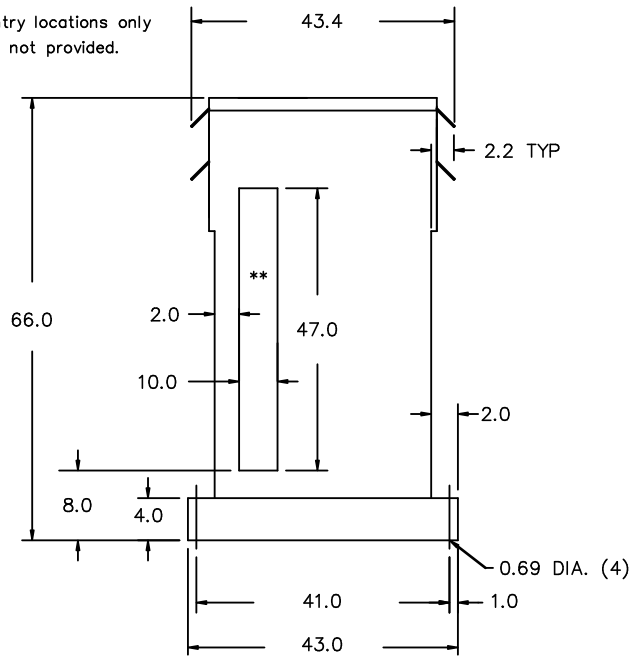

All Dimensions in inches

ENCLOSURE COLOR : ANSI 61 GREY - OUTDOOR

H.V.1. TERMINAL DETAIL

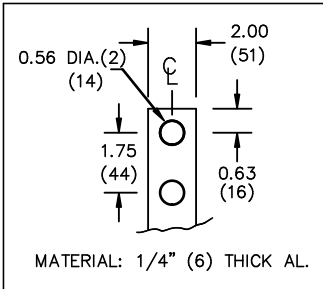

L.V.1. TERMINAL DETAIL

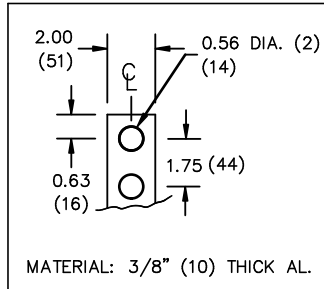

CUSTOMER NOTES:

- HV1 TERMINATED AT TOP FRONT
- LV1 TERMINATED AT BOTTOM FRONT
- C/W 1-"NC"- THERMOSTAT PER COIL CONNECTED TO T.B.

THIS DRAWING CONTAINS STRICTLY CONFIDENTIAL INFORMATION BELONGING TO HAMMOND POWER SOLUTIONS AND MUST NOT BE DISTRIBUTED OUTSIDE AUTHORIZED PARTIES.



TITLE: 3PH DRIVE TRANSFORMER

2	21/07/13	PP	EDB UPDATE	DES: GPATEL
1	15/09/09	JF	UPDATED TO MEET NEW STDS [HCN 61037]	DATE: 10/12/28
NO.	DATE	BY	REVISION	SCALE: NTS

SHEET 2 OF 2

EDBDM660N1

2.0 httpd 2026/04/02 02:43