



® LR 3902

UL DRY TYPE TRANSFORMER 774J5 E112313

LISTED

GUELPH, ONT. BARABOO, WI COMPTON, CA MONTERREY, MX

THREE PHASE DRY TYPE DRIVE ISOLATION TRANSFORMER
TRANSFORMATEUR TRIPHASE POUR VARIATEUR DE VITESSE DE MOTEURS

HV/HT	460V				Cust. Ref. Réf. du client	
BIL	-				Serial No. No. de série	
TERM. BORNES	H1 H2 H3				Part No. No. de pièce	DM660JJC
	VOLTS	CURRENT COURANT	% RATED VOLTAGE % TENSION NOMINALE	CONNECTION EACH PHASE CONNEXION PAR PHASE	kVA	660
	484	787	105.2	1-2	TYPE	K
	472	807	102.6	2-3	Cooling Refroidissement	ANN
	460	828	100	3-4	Temp. Rise Echauffement	150 °C
	448	850	97.4	4-5	Temp. Class Classe de Temp.	220 °C
	436	874	94.8	5-6	Frequency Fréquence	60 Hz
LV/BT	460Y/266V				Impédance % @ 170 °C	5.5
BIL	-				Encl. Type Type de boîtier	3R
TERM. BORNES	X0 X1 X2 X3				Wt Poids	3600 lbs
					Winding Enroulement	CU

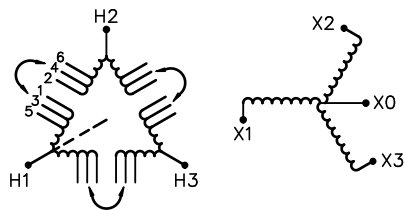

SPACINGS BETWEEN ANY VENTILATED ENCLOSURE PANEL AND ANY ADJACENT WALL SHALL BE A MINIMUM OF 12 INCHES

d003102b



TITLE: 3PH DRIVE TRANSFORMER
NAMEPLATE INFORMATION

2	21/07/16	PP	EDB UPDATE	DES: CYU
1	17/06/19	MA	HCN: 65892	DATE: 10/10/18
NO.	DATE	BY	REVISION	SCALE: NTS

SHEET 1 OF 2

EJBDM660JJC

FRONT VIEW

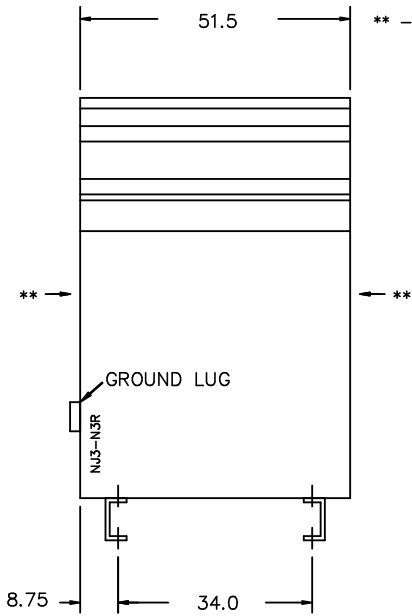

SIDE VIEW

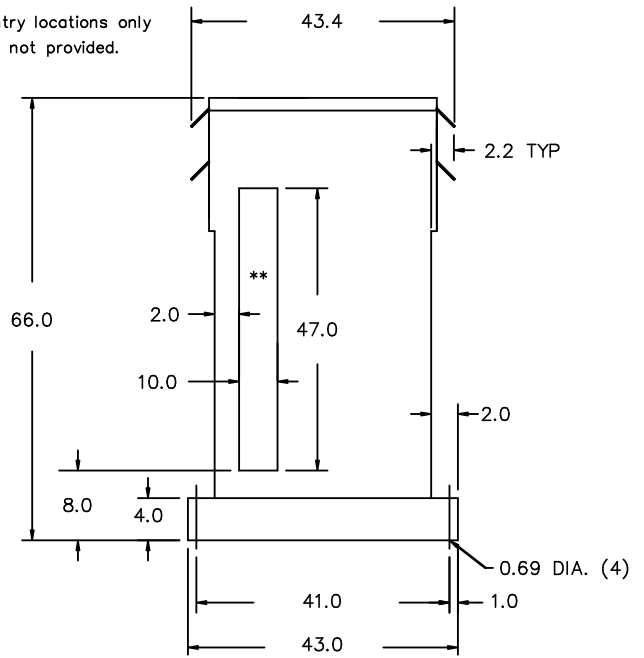

All Dimensions in inches

ENCLOSURE COLOR : ANSI 61 GREY - OUTDOOR

HV TERMINAL DETAIL

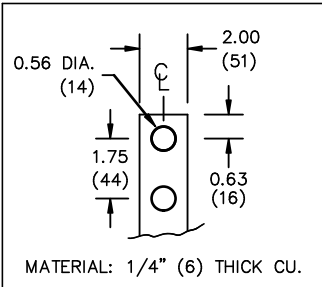

LV TERMINAL DETAIL

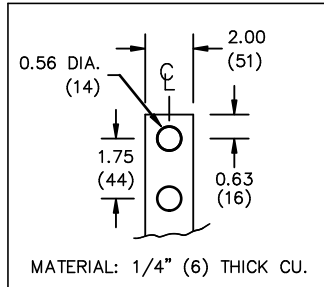

CUSTOMER NOTES:

- HV TERMINATED AT TOP FRONT
- LV TERMINATED AT BOTTOM FRONT
- C/W 1-"NC"- THERMOSTAT PER COIL CONNECTED TO T.B.



TITLE: 3PH DRIVE TRANSFORMER

2	21/07/16	PP	EDB UPDATE	DES: CYU
1	17/06/19	MA	HCN: 65892	DATE: 10/10/18
NO.	DATE	BY	REVISION	SCALE: NTS

SHEET 2 OF 2

EDBDM660JJC