

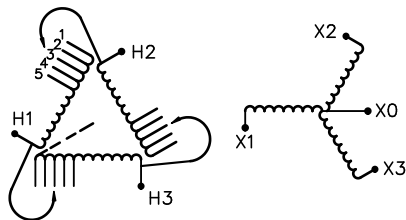

GUELPH, ONT. BARABOO, WI COMPTON, CA MONTERREY, MX

THREE PHASE DRY TYPE DRIVE ISOLATION TRANSFORMER
 TRANSFORMATEUR TRIPHASE POUR VARIATEUR DE VITESSE DE MOTEURS

HV/HT	480V			Cust. Ref. Réf. du client	
BIL	-			Serial No. No. de série	
TERM. BORNES	H1 H2 H3			Part No. No. de pièce	DM275KDC
	VOLTS	CURRENT COURANT	% RATED VOLTAGE % TENSION NOMINALE	CONNECTION EACH PHASE CONNEXION PAR PHASE	kVA
	504	315	105	1	275
	492	323	102.5	2	TYPE
	480	331	100	3	K
	468	339	97.5	4	Cooling Refroidissement
	456	348	95	5	ANN
					Temp. Rise Echauffement
					150 °C
					Temp. Class Classe de Temp.
					220 °C
					Frequency Fréquence
					60 Hz
					Impédance % @ 170 °C
					6
LV/BT	240Y/139V			Encl. Type Type de boîtier	3R
BIL	-			Wt Poids	1650
TERM. BORNES	X0 X1 X2 X3			Winding Enroulement	CU



SPACINGS BETWEEN ANY VENTILATED ENCLOSURE PANEL AND ANY ADJACENT WALL SHALL BE A MINIMUM OF 5 INCHES

D003102b



TITLE: 3PH DRIVE TRANSFORMER
 NAMEPLATE INFORMATION

2	21/07/16	PP	EDB UPDATE	DES: RBHATIA
1	14/04/27	RB	HCN: 27751	DATE: 06/05/04
NO.	DATE	BY	REVISION	SCALE: NTS

SHEET 1 OF 2

EJBDM275KDC

FRONT VIEW



** - Recommended cable entry locations only
cutouts & gland plates not provided.

SIDE VIEW



All Dimensions in inches

ENCLOSURE COLOR : ANSI 61 GREY - OUTDOOR

H.V.1. TERMINAL DETAIL

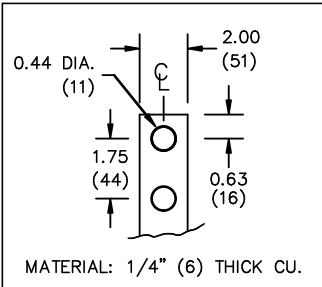

L.V.1. TERMINAL DETAIL

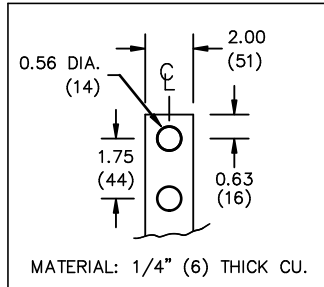

CUSTOMER NOTES:

- HV1 TERMINATED AT TOP FRONT
- LV1 TERMINATED AT BOTTOM FRONT
- C/W 1-"NC"- THERMOSTAT PER COIL CONNECTED TO T.B.

THIS DRAWING CONTAINS STRICTLY CONFIDENTIAL INFORMATION BELONGING TO HAMMOND POWER SOLUTIONS AND MUST NOT BE DISTRIBUTED OUTSIDE AUTHORIZED PARTIES.



TITLE: 3PH DRIVE TRANSFORMER

2	21/07/16	PP	EDB UPDATE	DES: RBHATIA
1	14/04/27	RB	HCN: 27751	DATE: 06/05/04
NO.	DATE	BY	REVISION	SCALE: NTS

SHEET 2 OF 2

EDBDM275KDC

2.0 httpd 2026/04/04 23:49