



® LR 3902

UL DRY TYPE TRANSFORMER 7745 E112313

LISTED

GUELPH, ONT. BARABOO, WI COMPTON, CA MONTERREY, MX

THREE PHASE DRY TYPE DRIVE ISOLATION TRANSFORMER  
TRANSFORMATEUR TRIPHASE POUR VARIATEUR DE VITESSE DE MOTEURS

HV/HT	480Y/277V			Cust. Ref. Réf. du client	
BIL	-			Serial No. No. de série	
TERM. BORNES	H0 H1 H2 H3			Part No. No. de pièce	DM220BK
	VOLTS	CURRENT COURANT	% RATED VOLTAGE % TENSION NOMINALE	CONNECTION EACH PHASE CONNEXION PAR PHASE	kVA
	218	582	105	1	220
	213	596	102.5	2	TYPE
	208	611	100	3	K
	203	626	97.5	4	Cooling Refroidissement
	198	643	95	5	ANN
					Temp. Rise Echauffement
					150 °C
					Temp. Class Classe de Temp.
					220 °C
					Frequency Fréquence
					60 Hz
					Impédance % @ 170 °C
					5.4
LV/BT	208V			Encl. Type Type de boîtier	3R
BIL	-			Wt Poids	1150
TERM. BORNES	X1 X2 X3			Winding Enroulement	AL

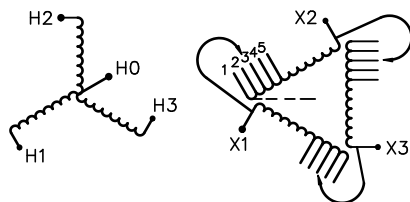

SPACINGS BETWEEN ENCLOSURE AND ANY ADJACENT WALL SHALL BE A MINIMUM OF 5 INCHES  
TRANSFORMER SUITABLE FOR STEP UP OPERATION ONLY

4003102b



TITLE: 3PH DISTRIBUTION TRANSFORMER  
NAMEPLATE INFORMATION

1	21/07/16	PP	EDB UPDATE	DES: JWEN
NO.	DATE	BY	REVISION	SCALE: NTS

SHEET 1 OF 2

EDBDM220BK

1.0 httpd 2026/04/03 02:36

THIS DRAWING CONTAINS STRICTLY CONFIDENTIAL INFORMATION BELONGING TO HAMMOND POWER SOLUTIONS AND MUST NOT BE DISTRIBUTED OUTSIDE AUTHORIZED PARTIES.

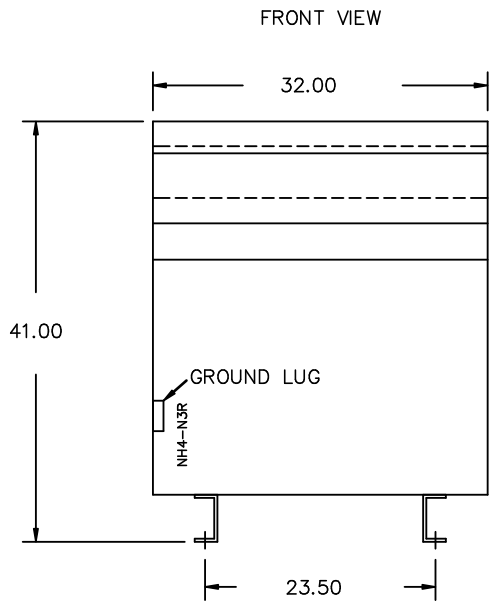

All Dimensions in inches

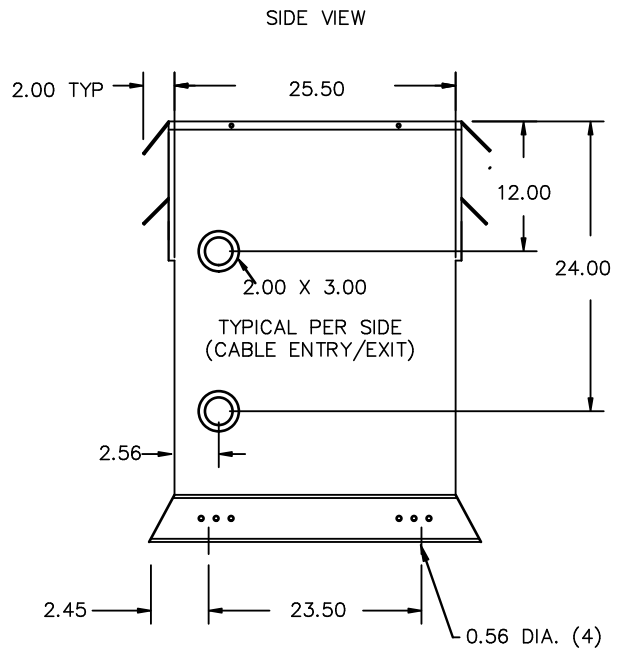

ENCLOSURE COLOR :ANSI 61 GREY – OUTDOOR

H.V.1. TERMINAL DETAIL

L.V.1. TERMINAL DETAIL

MECHANICAL TYPE LUGS INCLUDED  
SUITABLE FOR 600MCM-2 CU/AL  
CONDUCTORS  
1 CONDUCTOR PER PHASE

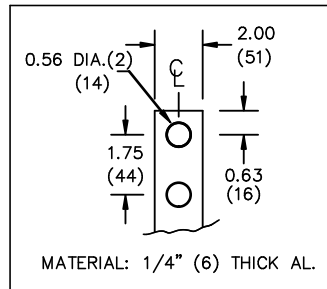

MATERIAL: 1/4" (6) THICK AL.

CUSTOMER NOTES:

- HV1 TERMINATED AT BOTTOM FRONT
- LV1 TERMINATED AT TOP FRONT
- C/W 1-"NC"-THERMOSTAT PER COIL CONNECTED TO T.B.



TITLE: 3PH DISTRIBUTION TRANSFORMER

1	21/07/16	PP	EDB UPDATE	DES: JWEN
NO.	DATE	BY	REVISION	SCALE: NTS

SHEET 2 OF 2

EDBDM220BK