



® LR 3902

UL DRY TYPE TRANSFORMER 774J5 E112313

LISTED

GUELPH, ONT. BARABOO, WI COMPTON, CA MONTERREY, MX

THREE PHASE DRY TYPE DRIVE ISOLATION TRANSFORMER
TRANSFORMATEUR TRIPHASE POUR VARIATEUR DE VITESSE DE MOTEURS

| | | | | | | |
|--------------|-------------------|--------------------|---|--|--------------------------------|---------|
| HV/HT | 480Y/277V | | | | Cust. Ref. Réf. du client | |
| BIL | - | | | | Serial No. No. de série | |
| TERM. BORNES | H0 H1 H2 H3 | | | | Part No. No. de pièce | DM118BK |
| | VOLTS | CURRENT COURANT | % RATED VOLTAGE % TENSION NOMINALE | CONNECTION EACH PHASE CONNEXION PAR PHASE | kVA | 118 |
| | 218 208 198 | 312 328 345 | 105 100 95 | 1 2 3 | TYPE | K |
| | 208V | | | | Cooling Refroidissement | ANN |
| LV/BT | | | | | Temp. Rise Echauffement | 150 °C |
| BIL | - | | | | Temp. Class Classe de Temp. | 220 °C |
| TERM. BORNES | X1 X2 X3 | | | | Frequency Fréquence | 60 Hz |
| | | | | | Impédance % @ 170 °C | 4.1 |
| | | | | | Encl. Type Type de boîtier | 3R |
| | | | | | Wt Poids | 750 lbs |
| | | | | | Winding Enroulement | AL |

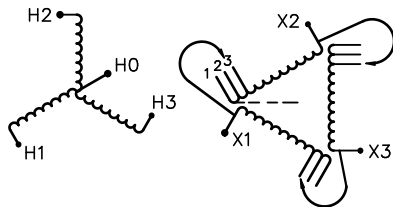

SPACINGS BETWEEN ANY VENTILATED ENCLOSURE PANEL AND ANY ADJACENT WALL SHALL BE A MINIMUM OF 5 INCHES EXCEPT WHEN WALL MOUNTED USING APPROVED WALL MOUNTING KIT TRANSFORMER SUITABLE FOR STEP UP OPERATION ONLY

d003102b



TITLE: 3PH DRIVE TRANSFORMER
NAMEPLATE INFORMATION

| | | | | |
|-----|----------|----|----------------|----------------|
| 2 | 21/07/16 | PP | EDB UPDATE | DES: RBHATIA |
| 1 | 20/06/25 | CS | DESIGN UPDATED | DATE: 04/05/04 |
| NO. | DATE | BY | REVISION | SCALE: NTS |

SHEET 1 OF 2

EDBDM118BK



All Dimensions in inches

ENCLOSURE COLOR :ANSI 61 GREY- OUTDOOR

HV TERMINAL DETAIL

LV TERMINAL DETAIL

MECHANICAL TYPE LUGS INCLUDED
SUITABLE FOR 250MCM-6 CU/AL
CONDUCTORS
1 CONDUCTOR PER PHASE

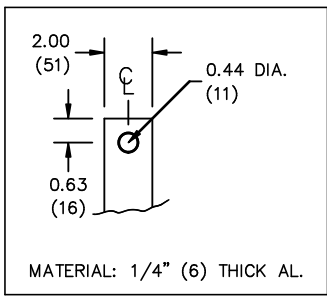

CUSTOMER NOTES:

- HV TERMINATED AT BOTTOM FRONT
- LV TERMINATED AT TOP FRONT
- C/W 1-"NC"- THERMOSTAT PER COIL CONNECTED TO T.B.



TITLE: 3PH DRIVE TRANSFORMER

| | | | | |
|-----|----------|----|----------------|----------------|
| 2 | 21/07/16 | PP | EDB UPDATE | DES: RBHATIA |
| 1 | 20/06/25 | CS | DESIGN UPDATED | DATE: 04/05/04 |
| NO. | DATE | BY | REVISION | SCALE: NTS |

SHEET 2 OF 2

EDBDM118BK