

hammond

POWER SOLUTIONS



US LISTED

E61431

GUELPH,ONT BARABOO,WI COMPTON,CA MONTERREY,MX

MADE IN CANADA

HPS Centurion S – 3 Phase SineWave Filter

| | | | |
|----------------|----------------------------------|---------------|--|
| RATING (HP) | <input type="text" value="250"/> | CUST. REF. | <input type="text"/> |
| SYS. VOLTAGE | <input type="text" value="480"/> | SERIAL NO. | <input type="text"/> |
| FREQ. (Hz) | <input type="text" value="90"/> | PART NO. | <input type="text" value="CS1K0305F"/> |
| CURRENT(AMP) | <input type="text" value="305"/> | TYPE | SJR-3 <input type="text" value="AN"/> |
| | | WDG MATERIAL | <input type="text" value="CU"/> |
| TEMP. RISE °C | <input type="text" value="130"/> | ENCL. TYPE | <input type="text"/> |
| TEMP. CLASS °C | <input type="text" value="220"/> | WEIGHT lbs/kg | <input type="text" value="275/125"/> |

WARNING: CAPACITOR VOLTAGE ABOVE 50V MAY REMAIN FOR 180 SECONDS AFTER POWER IS DISCONNECTED.

F0677EF

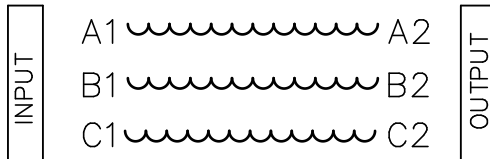

hammond

POWER SOLUTIONS

TITLE: LINE REACTOR
NAMEPLATE INFORMATION

| | | | | |
|-----|------|----|----------|----------------|
| | | | | DES: PBAKER |
| | | | | DATE: 24/01/19 |
| NO. | DATE | BY | REVISION | SCALE: NTS |

SHEET 1 OF 2

EDBCS1K0305F

∅ .8 LIFTING PROVISION

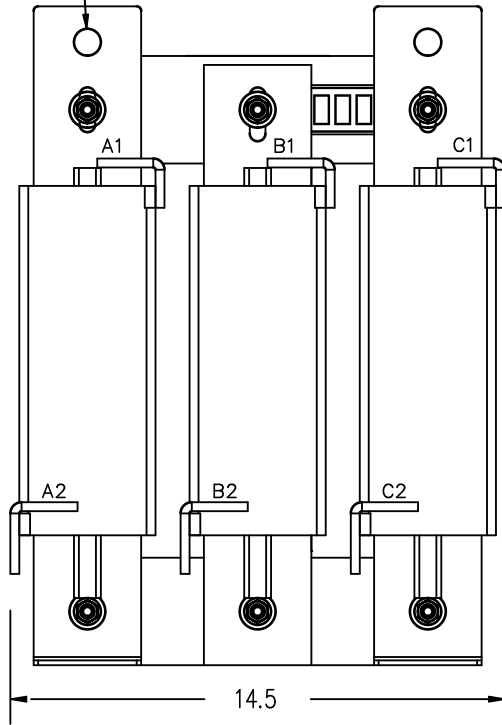

FRONT VIEW

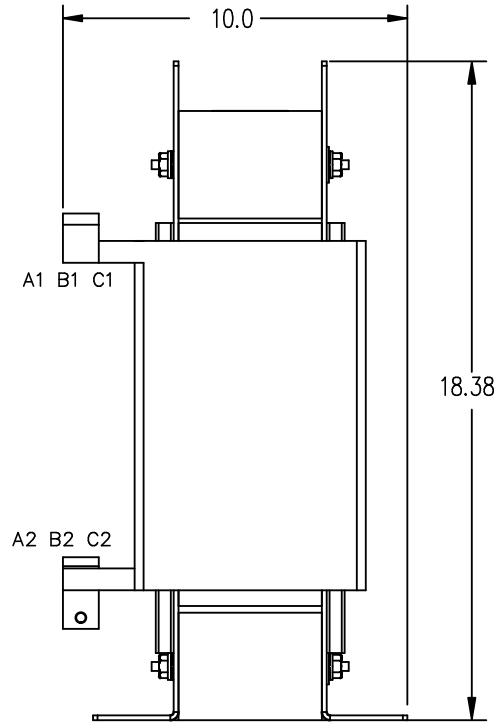

SIDE VIEW

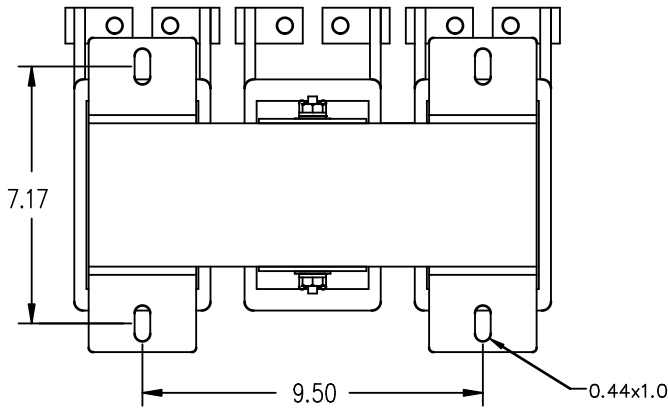

BOTTOM VIEW

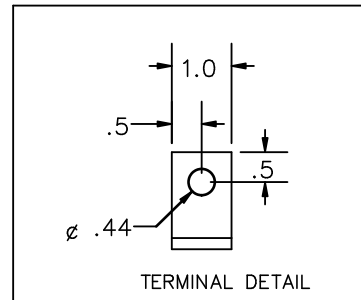

TERMINAL DETAIL



TOLERANCES
MOUNTING CENTERS = +/- .06"
MOUNTING HOLE SIZE = +/- .005"

THIS DRAWING CONTAINS PROPRIETARY INFORMATION
BELONGING TO HAMMOND POWER SOLUTIONS INC.,
AND IS NOT FOR GENERAL DISTRIBUTION

All Dimensions in Inches
mm in Parenthesis

FILTER



TITLE: LINE REACTOR
FLOOR MOUNT DIMENSIONS

| NO. | DATE | BY | REVISION | DES: PBAKER DATE: 24/01/19 SCALE: NTS |
|-----|------|----|----------|---|
| | | | | |

SHEET 2 OF 2

EDBCS1K0305F

0.0 httpd 2026/04/04 02:22 THIS DRAWING CONTAINS STRICTLY CONFIDENTIAL INFORMATION BELONGING TO HAMMOND POWER SOLUTIONS AND MUST NOT BE DISTRIBUTED OUTSIDE AUTHORIZED PARTIES.