

# hammond

POWER SOLUTIONS



US LISTED

E61431

GUELPH,ONT BARABOO,WI COMPTON,CA MONTERREY,MX

MADE IN CANADA

## HPS Centurion S – 3 Phase SineWave Filter

|                |                                  |               |  |
|----------------|----------------------------------|---------------|--|
| RATING (HP)    | <input type="text" value="75"/>  | CUST. REF.    | <input type="text"/>                   |
| SYS. VOLTAGE   | <input type="text" value="480"/> | SERIAL NO.    | <input type="text"/>                   |
| FREQ. (Hz)     | <input type="text" value="90"/>  | PART NO.      | <input type="text" value="CS1K0110C"/> |
| CURRENT(AMP)   | <input type="text" value="110"/> | TYPE SR-3     | <input type="text" value="ANN"/>       |
|                |                                  | WDG MATERIAL  | <input type="text" value="CU"/>        |
| TEMP. RISE °C  | <input type="text" value="130"/> | ENCL. TYPE    | <input type="text" value="3R"/>        |
| TEMP. CLASS °C | <input type="text" value="220"/> | WEIGHT lbs/kg | <input type="text" value="185/84"/>    |

F0677EF

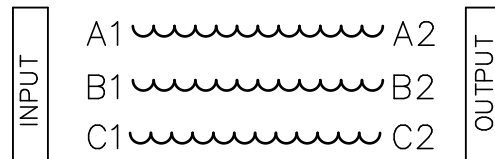

# hammond

POWER SOLUTIONS

TITLE: LINE REACTOR  
NAMEPLATE INFORMATION

|     |      |    |          |                |
|-----|------|----|----------|----------------|
|     |      |    |          | DES: PBAKER    |
|     |      |    |          | DATE: 25/01/31 |
| NO. | DATE | BY | REVISION | SCALE: NTS     |

SHEET 1 OF 2

EDBCS1K0110C

0.1 htpd 2026/04/03 04:08

THIS DRAWING CONTAINS STRICTLY CONFIDENTIAL INFORMATION BELONGING TO HAMMOND POWER SOLUTIONS AND MUST NOT BE DISTRIBUTED OUTSIDE AUTHORIZED PARTIES.

FRONT VIEW



SIDE VIEW



All Dimensions in inches

ENCLOSURE COLOR : ANSI 61 GREY – OUTDOOR

INPUT TERMINAL DETAIL

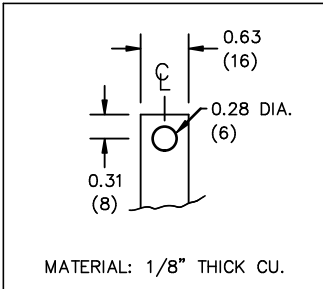

OUTPUT TERMINAL DETAIL

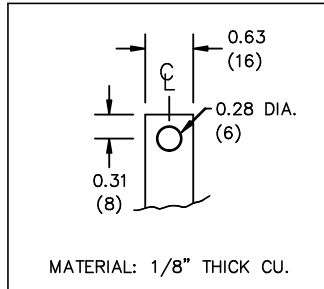

CUSTOMER NOTES:

- INPUT TERMINATED AT TOP FRONT
- OUTPUT TERMINATED AT BOTTOM FRONT



TITLE: LINE REACTOR  
ENCLOSURE & TERMINAL DETAIL

|     |      |    |          |                |
|-----|------|----|----------|----------------|
|     |      |    |          | DES: PBAKER    |
|     |      |    |          | DATE: 25/01/31 |
| NO. | DATE | BY | REVISION | SCALE: NTS     |

SHEET 2 OF 2

EDBCS1K0110C