

hammond

POWER SOLUTIONS



US LISTED

E61431

GUELPH,ONT BARABOO,WI COMPTON,CA MONTERREY,MX

MADE IN CANADA

HPS Centurion S – 3 Phase SineWave Filter

RATING (HP)	<input type="text" value="30"/>	CUST. REF.	<input type="text"/>
SYS. VOLTAGE	<input type="text" value="480"/>	SERIAL NO.	<input type="text"/>
FREQ. (Hz)	<input type="text" value="90"/>	PART NO.	<input type="text" value="CS1K0045C"/>
CURRENT(AMP)	<input type="text" value="45"/>	TYPE	SR-3 <input type="text" value="ANN"/>
		WDG MATERIAL	<input type="text" value="CU"/>
TEMP. RISE °C	<input type="text" value="130"/>	ENCL. TYPE	<input type="text" value="3R"/>
TEMP. CLASS °C	<input type="text" value="220"/>	WEIGHT lbs/kg	<input type="text" value="100/46"/>

USE WITH SUITABLY RATED LISTED (ZMVV) LUGS
WINDING TERMINAL TEMPERATURE: 75° C

F0677EF

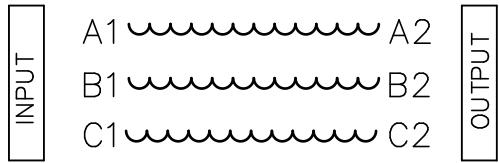

hammond

POWER SOLUTIONS

TITLE: IRON CORE LINE REACTOR
NAMEPLATE INFORMATION

				DES: PBAKER
				DATE: 25/02/20
NO.	DATE	BY	REVISION	SCALE: NTS

SHEET 1 OF 2

EDBCS1K0045C

0.1 htpd 2026/06/12 20:36 THIS DRAWING CONTAINS STRICTLY CONFIDENTIAL INFORMATION BELONGING TO HAMMOND POWER SOLUTIONS AND MUST NOT BE DISTRIBUTED OUTSIDE AUTHORIZED PARTIES.

FRONT VIEW



SIDE VIEW



All Dimensions in inches

ENCLOSURE COLOR : ANSI-61 GREY PAINT OUTDOOR

INPUT TERMINAL DETAIL

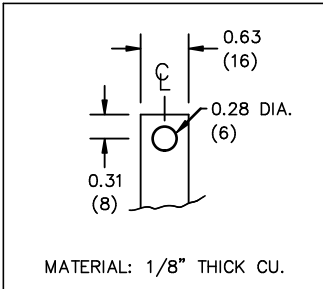

OUTPUT TERMINAL DETAIL

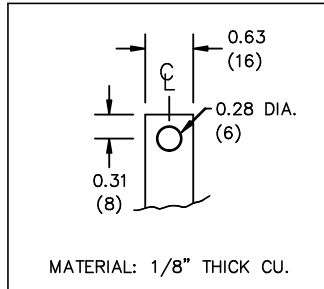

CUSTOMER NOTES:

- INPUT TERMINATED AT TOP FRONT
- OUTPUT TERMINATED AT BOT FRONT



TITLE: IRON CORE LINE REACTOR
ENCLOSURE & TERMINATION DETAIL

				DES: PBAKER
				DATE: 25/02/20
NO.	DATE	BY	REVISION	SCALE: NTS

SHEET 2 OF 2

EDBCS1K0045C

0.1 httpd 2026/06/12 20:36

THIS DRAWING CONTAINS STRICTLY CONFIDENTIAL INFORMATION BELONGING TO HAMMOND POWER SOLUTIONS AND MUST NOT BE DISTRIBUTED OUTSIDE AUTHORIZED PARTIES.