

TERMINAL BLOCK
SUITABLE FOR
#13 TO #10 AWG
CONDUCTORS
QTY. 1 PER PHASE

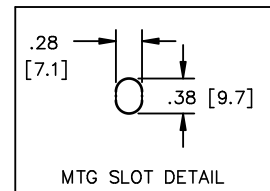

TOLERANCES
MOUNTING CENTERS = $\pm .06"$
MOUNTING HOLE SIZE = $\pm .005"$

THIS DRAWING CONTAINS PROPRIETARY INFORMATION
BELONGING TO HAMMOND POWER SOLUTIONS INC.,
AND IS NOT FOR GENERAL DISTRIBUTION

All Dimensions in Inches
mm in Parenthesis

REACTOR

hammond HPS CENTURION R
POWER SOLUTIONS 3PH DRY TYPE
REACTOR
CRX16D7BC
0.59MH 50/60 HZ 16.7 AMPS
0.6 KV CLASS TEMP CLASS: 130 TYPE JR-1
TERMINAL TORQUE: 11 LB-IN AMBIENT: 50°C

f003781e

NOTES:



TITLE: 3 PHASE LINE REACTOR

				DES: PBAKER
				DATE: 14/06/24
NO.	DATE	BY	REVISION	SCALE: NTS

SHEET 1 OF 1

EDBCRX16D7BC

48 19:17 2023/08/08 jwen 0.0