



TITLE: IRON CORE LINE REACTOR  
NAMEPLATE INFORMATION

NO.	DATE	BY	REVISION	DES: PBAKER
				DATE: 14/08/01
				SCALE: NTS

SHEET 1 OF 2

EDBCRX0528BE

INDUCT. 0.018 MH 50/60 HZ  
0.6 KV CLASS WT: 130 lbs  
AMBIENT: 50° TEMP CLASS: 220 TYPE JR-2A  
USE WITH SUITABLY RATED LISTED (ZMWV) LUGS  
WINDING TERMINAL TEMPERATURE: 75° C

HPS CENTURION R  
3PH DRY TYPE  
REACTOR

P/N CRX0528BE  
528 AMPS  
ENCL. TYPE 1/IP00

MADE IN CANADA  
f003783e

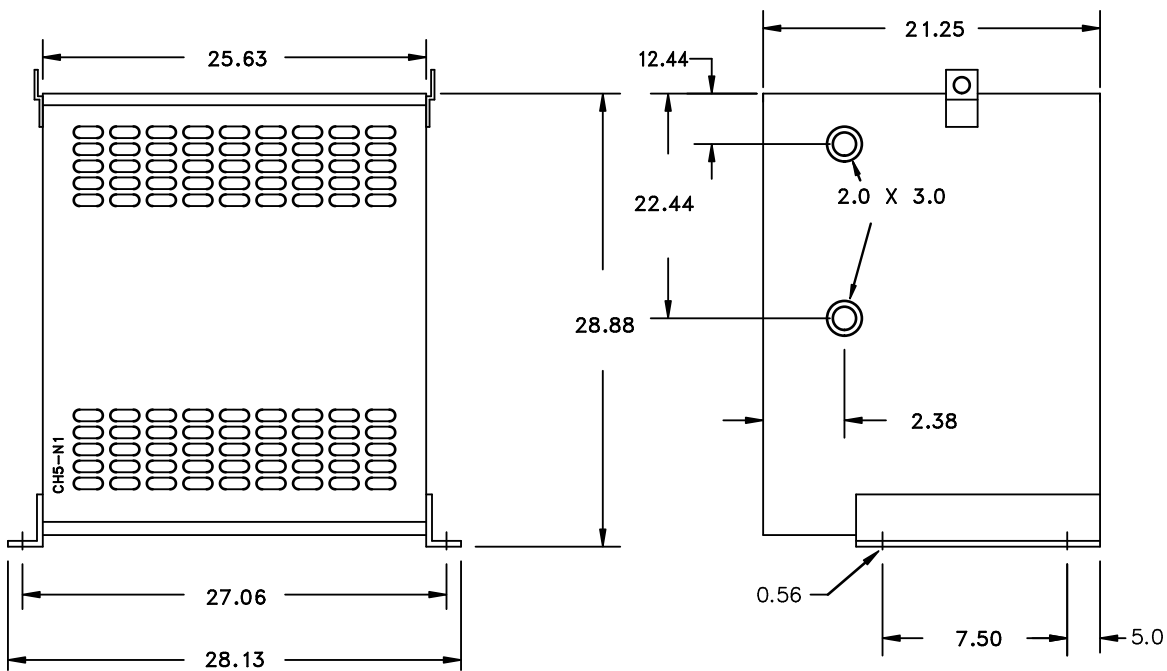

All Dimensions in inches

ENCLOSURE COLOR :ANSI 61 GREY – INDOOR

IN TERMINAL DETAIL

OUT TERMINAL DETAIL

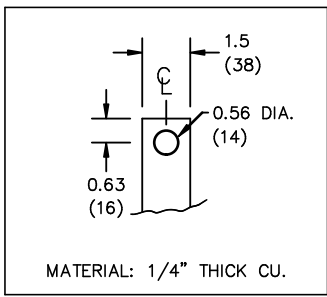
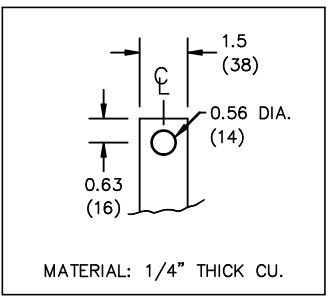

CUSTOMER NOTES:

- IN TERMINATED AT BOTTOM FRONT
- OUT TERMINATED AT TOP FRONT



TITLE: IRON CORE LINE REACTOR				DES: PBAKER
				DATE: 14/08/01
NO.	DATE	BY	REVISION	SCALE: NTS

SHEET 2 OF 2

EDBCRX0528BE

0.0 httpd 2026/04/04 04:41

THIS DRAWING CONTAINS STRICTLY CONFIDENTIAL INFORMATION BELONGING TO HAMMOND POWER SOLUTIONS AND MUST NOT BE DISTRIBUTED OUTSIDE AUTHORIZED PARTIES.