

FRONT VIEW

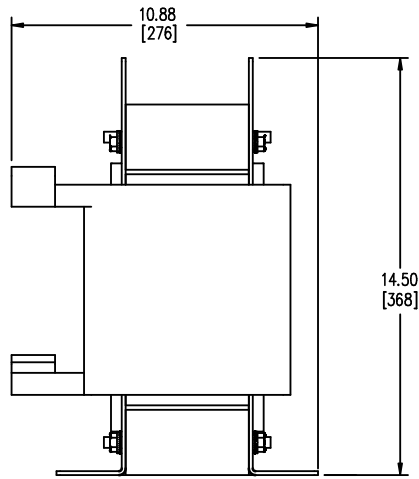

SIDE VIEW

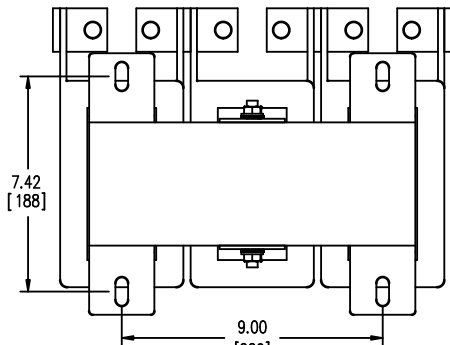

BOTTOM VIEW

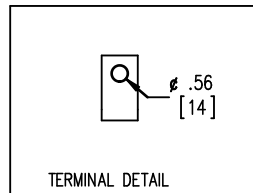

TERMINAL DETAIL

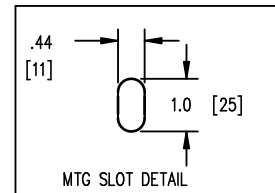

MTG SLOT DETAIL



TOLERANCES
MOUNTING CENTERS = +/- .06"
MOUNTING HOLE SIZE = +/- .005"

THIS DRAWING CONTAINS PROPRIETARY INFORMATION
BELONGING TO HAMMOND POWER SOLUTIONS INC.,
AND IS NOT FOR GENERAL DISTRIBUTION

All Dimensions in Inches
mm in Parenthesis

REACTOR

hammond 
POWER SOLUTIONS

HPS CENTURION R
3PH DRY TYPE
REACTOR

P/N CRX0477AC

INDUCT. 0.046 MH 50/60 HZ 477 AMPS

0.6 KV CLASS WT: 145/66 lbs/kg IP00

AMBIENT: 50° TEMP CLASS: 220 TYPE JR-2

USE WITH SUITABLY RATED LISTED (ZMVV) LUGS

WINDING TERMINAL TEMPERATURE: 75° C



MADE IN CANADA

IND. CONT. EQ. E61431

NOTES:

hammond 
POWER SOLUTIONS

TITLE: PROTOTYPE REACTOR

NO.	DATE	BY	REVISION

DES:	DATE:	SCALE:
PBAKER	14/07/04	NTS

SHEET 1 OF 1

EDBCRX0477AC

0.1 jwen 2023/08/17 19:37