



TITLE: IRON CORE LINE REACTOR  
NAMEPLATE INFORMATION

| NO. | DATE | BY | REVISION | DES: PBAKER    |
|-----|------|----|----------|----------------|
|     |      |    |          | DATE: 14/07/31 |
|     |      |    |          | SCALE: NTS     |

SHEET 1 OF 2

EDBCRX0192BE

**hammond**  
POWER SOLUTIONS

HPS CENTURION R  
3PH DRY TYPE  
REACTOR

P/N CRX0192BE

INDUCT. 0.245 MH 50/60 HZ 192 AMPS

0.6 KV CLASS WT: 121 lbs ENCL. TYPE 1/IP20

AMBIENT: 50° TEMP CLASS: 220 TYPE JR-3A

USE WITH SUITABLY RATED LISTED (ZMWV) LUGS  
WINDING TERMINAL TEMPERATURE: 75° C

MADE IN CANADA  
f003783e

LR3902

IND. CONT. EQ. E61431  
LISTED

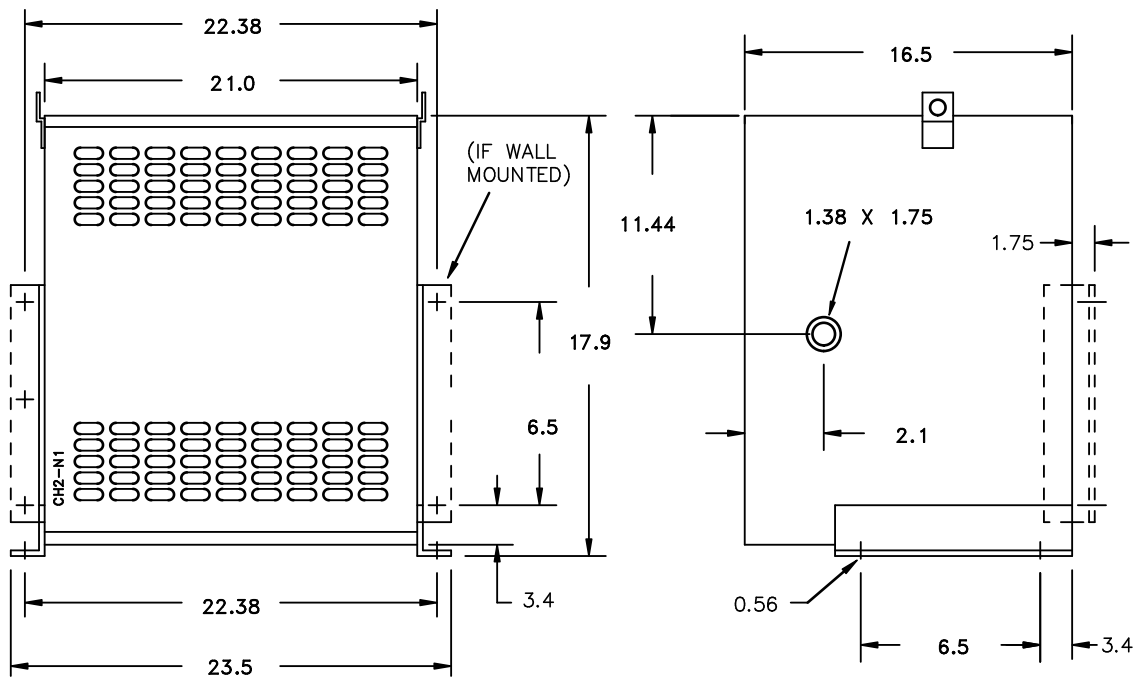

All Dimensions in inches

ENCLOSURE COLOR : ANSI 61 GREY – INDOOR

IN TERMINAL DETAIL

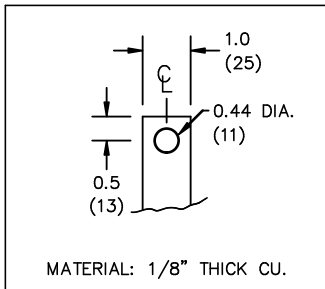

OUT TERMINAL DETAIL

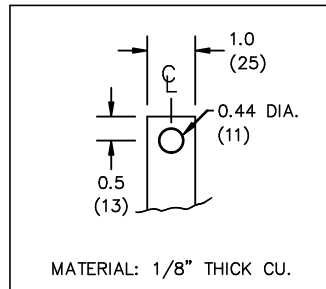

CUSTOMER NOTES:

- IN TERMINATED AT BOTTOM FRONT
- OUT TERMINATED AT TOP FRONT



TITLE: IRON CORE LINE REACTOR

|        |          |
|--------|----------|
| DES:   | PBAKER   |
| DATE:  | 14/07/31 |
| SCALE: | NTS      |

| NO. | DATE | BY | REVISION |
|-----|------|----|----------|
|     |      |    |          |

SHEET 2 OF 2

EDBCRX0192BE