



TITLE: IRON CORE LINE REACTOR
NAMEPLATE INFORMATION

| NO. | DATE | BY | REVISION | DES: PBAKER |
|-----|------|----|----------|----------------|
| | | | | DATE: 14/07/31 |
| | | | | SCALE: NTS |

SHEET 1 OF 2

EDBCRX0143CE

hammond
POWER SOLUTIONS

HPS CENTURION R
3PH DRY TYPE
REACTOR

P/N CRX0143CE

INDUCT. 0.114 MH 50/60 HZ 143 AMPS

0.6 KV CLASS WT: 38 lbs ENCL. TYPE 1/IP20

AMBIENT: 50° TEMP CLASS: 220 TYPE JR-2A

USE WITH SUITABLY RATED LISTED (ZMWV) LUGS
WINDING TERMINAL TEMPERATURE: 75° C

MADE IN CANADA
f003783e



All Dimensions in inches

ENCLOSURE COLOR :ASA 61 GREY

IN TERMINAL DETAIL

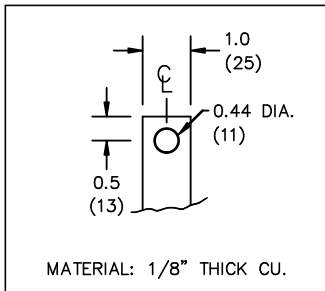

OUT TERMINAL DETAIL

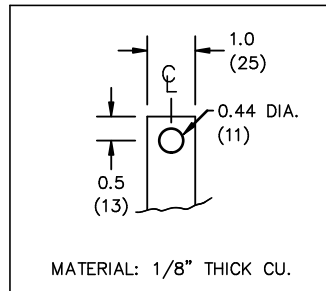

CUSTOMER NOTES:

- IN TERMINATED AT BOTTOM FRONT
- OUT TERMINATED AT TOP FRONT



TITLE: IRON CORE LINE REACTOR

| | | | | |
|-----|------|----|----------|----------------|
| | | | | DES: PBAKER |
| | | | | DATE: 14/07/31 |
| NO. | DATE | BY | REVISION | SCALE: NTS |

SHEET 2 OF 2

EDBCRX0143CE