



TITLE: 3 PHASE LINE REACTOR  
NAMEPLATE INFORMATION

NO.	DATE	BY	REVISION	DES:	SCALE:
				ASETH	NTS

SHEET 1 OF 2

EDBCRX0059DE

**hammond**  
POWER SOLUTIONS

HPS CENTURION R  
3PH DRY TYPE  
REACTOR

P/N CRX0059DE

INDUCT. 0.36 MH 50/60 HZ  
59 AMPS

0.6 KV CLASS WT: 35 lbs  
ENCL. TYPE 1/IP20

AMBIENT: 50° TEMP CLASS: 180 TYPE JR-2A

USE WITH SUITABLY RATED LISTED (ZMWV) LUGS  
WINDING TERMINAL TEMPERATURE: 75° C

MADE IN CANADA  
f003783e

LR3902

IND. CONT. EQ. E61431  
LISTED



All Dimensions in inches

ENCLOSURE COLOR :ASA 61 GREY

IN TERMINAL DETAIL

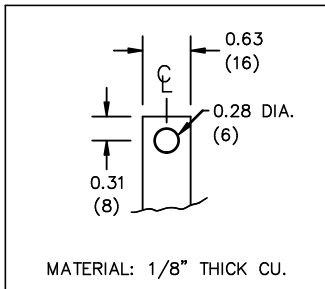

OUT TERMINAL DETAIL

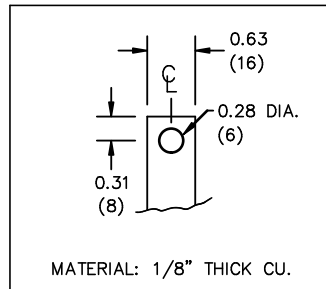

CUSTOMER NOTES:

- IN TERMINATED AT BOTTOM FRONT
- OUT TERMINATED AT TOP FRONT



TITLE: 3 PHASE LINE REACTOR  
MECHANICAL INFORMATION

				DES: ASETH
				DATE: 14/07/22
NO.	DATE	BY	REVISION	SCALE: NTS

SHEET 2 OF 2

EDBCRX0059DE