



TITLE: 3 PHASE LINE REACTOR NAMEPLATE INFORMATION			
DES:	ASETH		
DATE:	14/07/22		
SCALE:	NTS		
NO.	DATE	BY	REVISION

SHEET 1 OF 2

EDBCRX0059BE

hammond
POWER SOLUTIONS

HPS CENTURION R
3PH DRY TYPE
REACTOR

P/N CRX0059BE

INDUCT. 0.22 MH 50/60 HZ 59 AMPS

0.6 KV CLASS WT: 28.0 lbs ENCL. TYPE 1/IP20

AMBIENT: 50° TEMP CLASS: 180 TYPE JR-1A

USE WITH SUITABLY RATED LISTED (ZMWV) LUGS
WINDING TERMINAL TEMPERATURE: 75° C

MADE IN CANADA
f003783e

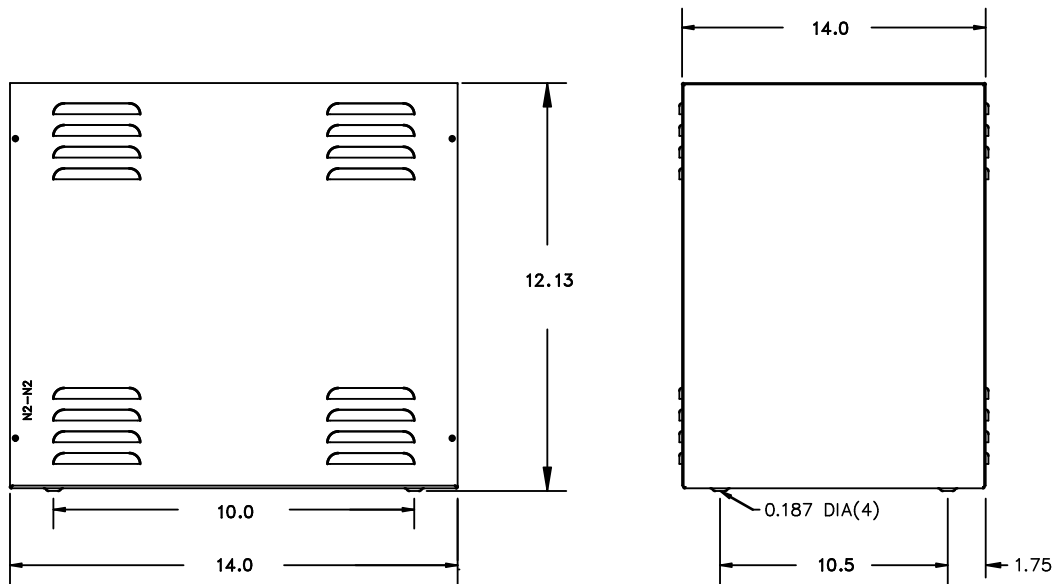

All Dimensions in inches

ENCLOSURE COLOR :ASA 61 GREY

IN TERMINAL DETAIL

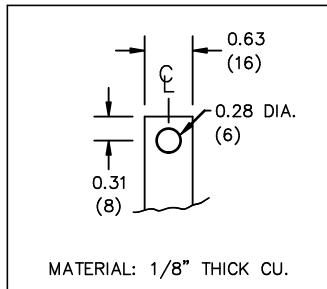

OUT TERMINAL DETAIL

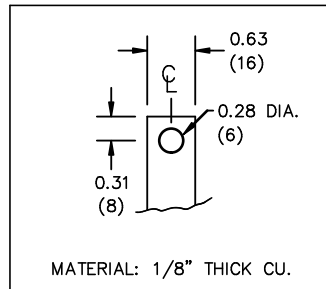

CUSTOMER NOTES:

- IN TERMINATED AT BOTTOM FRONT
- OUT TERMINATED AT TOP FRONT



TITLE: 3 PHASE LINE REACTOR
MECHANICAL INFORMATION

NO.	DATE	BY	REVISION	DES: ASETH
				DATE: 14/07/22
				SCALE: NTS

SHEET 2 OF 2

EDBCRX0059BE