

TERMINAL BLOCK  
SUITABLE FOR  
#14 TO #4 AWG  
CONDUCTORS  
QTY. 1 PER PHASE

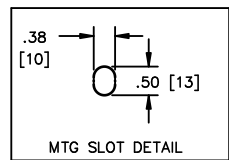

TOLERANCES  
MOUNTING CENTERS = +/- .06"  
MOUNTING HOLE SIZE = +/- .005"

THIS DRAWING CONTAINS PROPRIETARY INFORMATION  
BELONGING TO HAMMOND POWER SOLUTIONS INC.,  
AND IS NOT FOR GENERAL DISTRIBUTION

All Dimensions in Inches  
mm in Parenthesis

REACTOR



HPS CENTURION R  
3PH DRY TYPE  
REACTOR



MADE IN CANADA P/N CRX0052BC

INDUCT. 0.43 mH Hz 50/60 AMPS 52 IP00

0.6 kV CLASS TEMP CLASS 180°C TYPE JR



WEIGHT 18/9 (LBS/KG) AMBIENT: 50°C E61431 LR3902

f00377/6eaur

NOTES:



TITLE: 3 PHASE LINE REACTOR

1	24/05/21	PB	HCN: 80927	DES: PBAKER
NO.	DATE	BY	REVISION	SCALE: NTS

SHEET 1 OF 1

EDBCRX0052BC

1.0 httpd 2026/04/03 21:12 THIS DRAWING CONTAINS STRICTLY CONFIDENTIAL INFORMATION BELONGING TO HAMMOND POWER SOLUTIONS AND MUST NOT BE DISTRIBUTED OUTSIDE AUTHORIZED PARTIES.