

TERMINAL BLOCK
SUITABLE FOR
#14 TO #4 AWG
CONDUCTORS
QTY. 1 PER PHASE

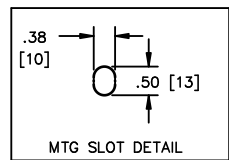

TOLERANCES
MOUNTING CENTERS = +/- .06"
MOUNTING HOLE SIZE = +/- .005"

THIS DRAWING CONTAINS PROPRIETARY INFORMATION
BELONGING TO HAMMOND POWER SOLUTIONS INC.,
AND IS NOT FOR GENERAL DISTRIBUTION

All Dimensions in Inches
mm in Parenthesis

REACTOR



HPS CENTURION R
3PH DRY TYPE
REACTOR

MADE IN CANADA P/N CRX0023PC

INDUCT. 1.52 mH Hz 50/60 AMPS 23 IP00

0.6 kV CLASS TEMP CLASS 180°C TYPE JR

WEIGHT 18 (LBS/KG) AMBIENT: 50°C



LR3902



LISTED

f003776oe

NOTES:



TITLE: 3 PHASE LINE REACTOR				
				DES: PBAKER
				DATE: 17/03/08
NO.	DATE	BY	REVISION	SCALE: NTS

SHEET 1 OF 1
EDBCRX0023PC

THIS DRAWING CONTAINS STRICKLY CONFIDENTIAL INFORMATION BELONGING TO HAMMOND POWER SOLUTIONS AND MUST NOT BE DISTRIBUTED OUTSIDE AUTHORIZED PARTIES.
0.0 httpd 2026/04/04 07:43