



GENERAL PURPOSE TRANSFORMER 252L E50394

GUELPH, ONT. BARABOO, WI COMPTON, CA MONTERREY, MX

COMMERCIAL POTTED DISTRIBUTION TRANSFORMER

HV/HT	347/380V				Cust. Ref.	
BIL	-				Réf. du client	
TERM. BORNES	H1 H2 H3				Serial No. No. de série	
					Part No. No. de pièce	C1FC10JE
					Phase	1
	VOLTS	CURRENT COURANT	% RATED VOLTAGE % TENSION NOMINALE	CONNECTION EACH PHASE CONNECTION PAR PHASE	kVA	0.1
	347 380	0.3 0.3		H1-H2 H1-H3	TYPE	Q
					Cooling Refroidissement	ANC
					Temp. Class Classe de Temp.	130 °C
					Frequency Fréquence	50/60Hz
					Impédance % @ °C	
LV/BT	120/240V 0.8/0.4A				Encl. Type Type de boîtier	3R
BIL	-				Wt Poids	9.1/4.1 lbs
TERM. BORNES	X4 X2 X3 X1					

1-UL-4151-0000P

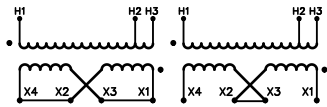

TITLE: 1 PHASE ENCAPSULATED TRANSFORMER NAMEPLATE INFORMATION

3	26/04/17	MS	UPDATED PER NEW DESIGN	DES:	LCEN
2	21/07/16	PP	EDB UPDATE	DATE:	08/12/16
NO.	DATE	BY	REVISION	SCALE:	NTS

SHEET 1 OF 2

EJBC1FC10JE

FRONT VIEW



FRONT & BOTTOM PANEL IS HINGED FOR ACCESS TO TERMINALS, BOTTOM MOUNTING HOLES AND REAR KNOCKOUT.

All Dimensions in inches

SIDE VIEW

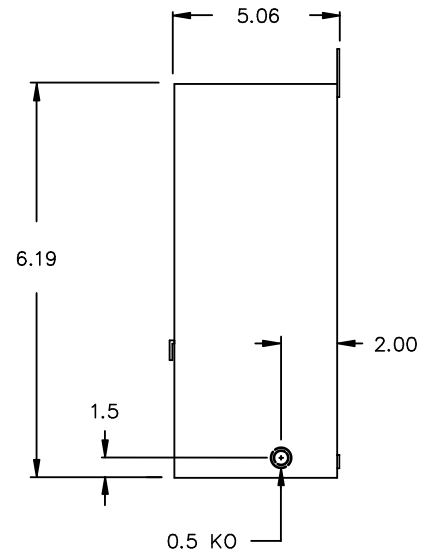

ENCLOSURE COLOR : ANSI 61 GREY – OUTDOOR

CUSTOMER NOTES:

- HV TERMINATED AT #18 AWG LEAD WIRE
- LV TERMINATED AT #18 AWG LEAD WIRE



TITLE: 1 PHASE ENCAPSULATED TRANSFORMER

3	26/04/17	MS	UPDATED PER NEW DESIGN	DES: LCEN
2	21/07/16	PP	EDB UPDATE	DATE: 08/12/16
NO.	DATE	BY	REVISION	SCALE: NTS

SHEET 2 OF 2

EDBC1FC10JE