



GENERAL PURPOSE TRANSFORMER 252L E50394

GUELPH, ONT. BARABOO, WI COMPTON, CA MONTERREY, MX

COMMERCIAL POTTED DISTRIBUTION TRANSFORMER

HV/HT	480/277V			Cust. Ref. Réf. du client	
BIL	-			Serial No. No. de série	
TERM. BORNES	H1 H2			Part No. No. de pièce	C1F010HRS
	VOLTS	CURRENT COURANT	% RATED VOLTAGE % TENSION NOMINALE	CONNECTION EACH PHASE CONNEXION PAR PHASE	Phase
	480 277	20.8 36.1		1-2 3-4	1
	277 208			X5-X6 X3-X4	kVA
LV/BT	208V/277V			TYPE	Q
BIL	-			Cooling Refroidissement	ANC
TERM. BORNES	X2 X1			Temp. Class Classe de Temp.	180 °C
				Frequency Fréquence	50/60Hz
				Impédance % @ 135 °C	3.5
				Encl. Type Type de boîtier	3R
				Wt Poids	200 lbs

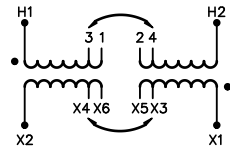

ELECTROSTATIC SHIELD

4000001344

HAM1373



TITLE: 1PH DISTRIBUTION TRANSFORMER NAMEPLATE INFORMATION

2	21/07/13	PP	EDB UPDATE	DES: LCEN
1	20/10/30	LC	CHANGED TERMINATED AT	DATE: 08/10/16
NO.	DATE	BY	REVISION	SCALE: NTS

SHEET 1 OF 2

EDBC1F010HRS

FRONT VIEW

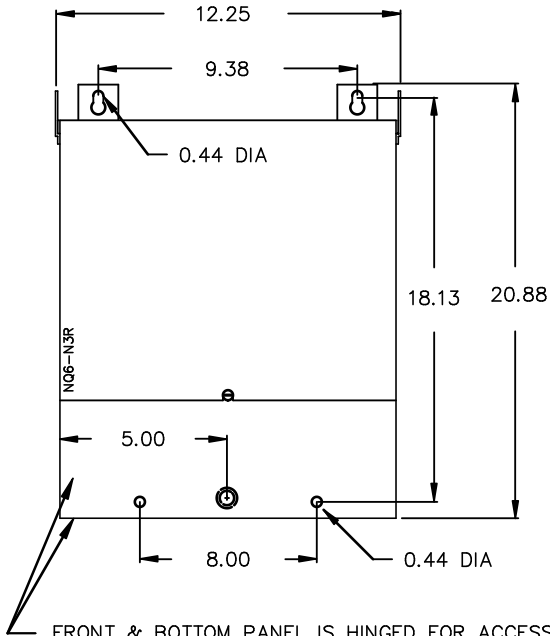

SIDE VIEW

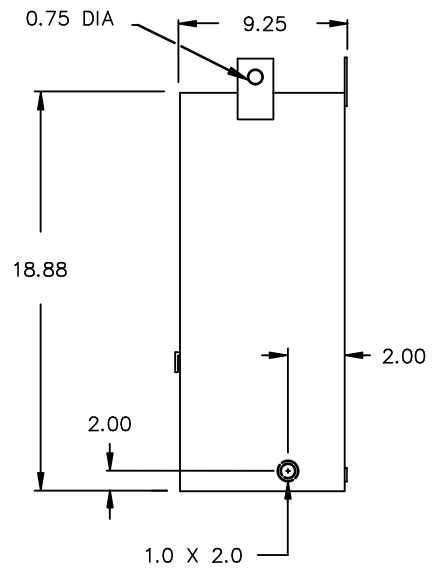

FRONT & BOTTOM PANEL IS HINGED FOR ACCESS TO TERMINALS, BOTTOM MOUNTING HOLES AND REAR KNOCKOUT.

All Dimensions in inches

ENCLOSURE COLOR : ANSI 61 GREY – OUTDOOR

CUSTOMER NOTES:

- HV1 TERMINATED AT SEW LEADS
- LV1 TERMINATED AT SEW LEADS
- LV: 208V/277V: #6SEW LEADS
- HV: 277/480V: #8SEW LEADS

THIS DRAWING CONTAINS STRICTLY CONFIDENTIAL INFORMATION BELONGING TO HAMMOND POWER SOLUTIONS AND MUST NOT BE DISTRIBUTED OUTSIDE AUTHORIZED PARTIES.



TITLE: 1PH DISTRIBUTION TRANSFORMER

2	21/07/13	PP	EDB UPDATE	DES: LCEN
1	20/10/30	LC	CHANGED TERMINATED AT	DATE: 08/10/16
NO.	DATE	BY	REVISION	SCALE: NTS

SHEET 2 OF 2

EDBC1F010HRS

2.0 httpd 2026/06/23 20:28