



GENERAL PURPOSE TRANSFORMER 252L E50394

GUELPH, ONT. BARABOO, WI COMPTON, CA MONTERREY, MX

HPS FORTRESS™
COMMERCIAL POTTED DISTRIBUTION TRANSFORMER

HV/HT	120X240V			Cust. Ref.	
BIL	-			Réf. du client	
TERM. BORNES	H1 H2			Serial No.	
				No. de série	
				Part No.	C1F010EES
				No. de pièce	
				Phase	1
				kVA	10
				TYPE	Q
				Cooling Refroidissement	ANC
				Temp. Class. Classe de Temp.	180 °C
				Frequency Fréquence	60 Hz
				Impédance % @ 135 °C	3.7
				Encl. Type Type de boîtier	NEMA-3R
				Wt Poids	185 lbs
LV/BT	120/240V				
BIL	-				
TERM. BORNES	X4 X2 X3 X1				

VOLTS	CURRENT COURANT	% RATED VOLTAGE % TENSION NOMINALE	CONNECTION EACH PHASE CONNEXION PAR PHASE
252	39.7	105	1-2
246	40.7	102.5	2-3
240	41.7	100	3-4
234	42.7	97.5	4-5
228	43.9	95	5-6
222	45.0	92.5	6-7
216	46.3	90	7-8
120	83.3	100	H1-4, H2-3
114	87.7	95	H1-6, H2-5
108	92.6	90	H1-8, H2-7

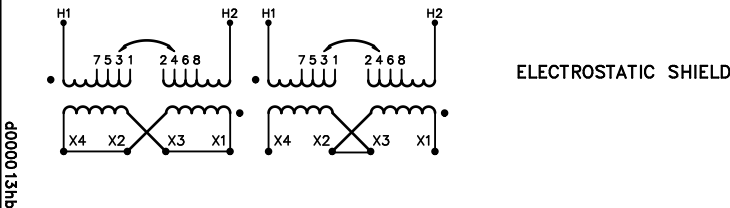

TITLE: 1PH DISTRIBUTION TRANSFORMER NAMEPLATE INFORMATION				
1	21/07/13	PP	EDB UPDATE	DES: LCEN
NO.	DATE	BY	REVISION	SCALE: NTS

SHEET 1 OF 2
EDBC1F010EES

THIS DRAWING CONTAINS STRICTLY CONFIDENTIAL INFORMATION BELONGING TO HAMMOND POWER SOLUTIONS AND MUST NOT BE DISTRIBUTED OUTSIDE AUTHORIZED PARTIES. 1.0 httpd 2026/04/04 17:15

FRONT VIEW

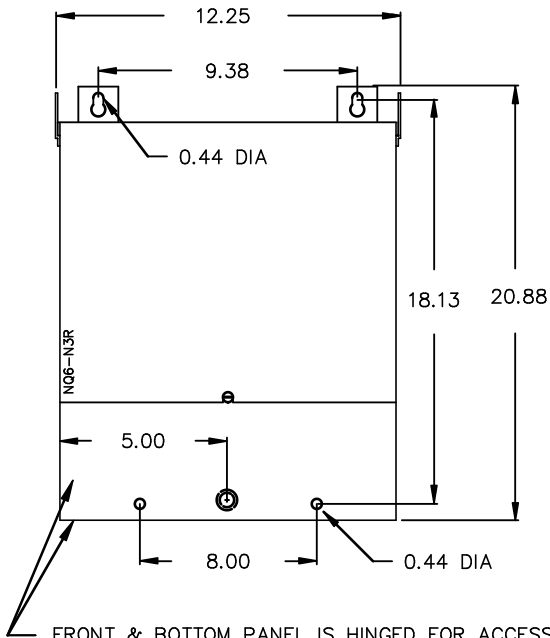

SIDE VIEW

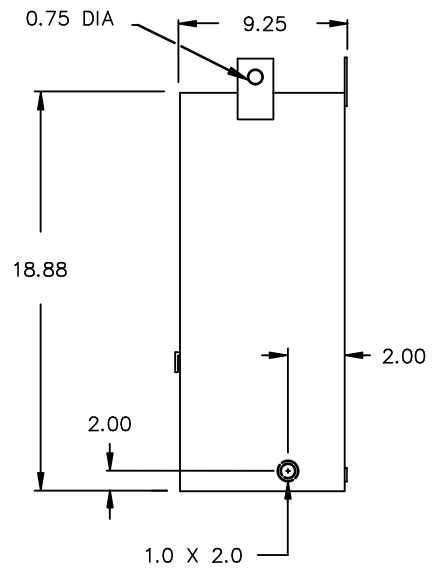

FRONT & BOTTOM PANEL IS HINGED FOR ACCESS TO TERMINALS, BOTTOM MOUNTING HOLES AND REAR KNOCKOUT.

All Dimensions in inches

ENCLOSURE COLOR : ANSI 61 GREY – OUTDOOR

CUSTOMER NOTES:

- HV1 TERMINATED AT BOTTOM REAR
- LV1 TERMINATED AT BOTTOM FRONT

THIS DRAWING CONTAINS STRICTLY CONFIDENTIAL INFORMATION BELONGING TO HAMMOND POWER SOLUTIONS AND MUST NOT BE DISTRIBUTED OUTSIDE AUTHORIZED PARTIES.



TITLE: 1PH DISTRIBUTION TRANSFORMER

1	21/07/13	PP	EDB UPDATE	DES: LCEN
NO.	DATE	BY	REVISION	SCALE: NTS

SHEET 2 OF 2

EDBC1F010EES

1.0 httpd 2026/04/04 17:15