



GENERAL PURPOSE TRANSFORMER 252L E50394

GUELPH, ONT. BARABOO, WI COMPTON, CA MONTERREY, MX

HPS FORTRESS™  
COMMERCIAL POTTED DISTRIBUTION TRANSFORMER

|              |             |                    |                                       |  |                                |         |
|--------------|-------------|--------------------|---------------------------------------|--|--------------------------------|---------|
| HV/HT        | 277V        |                    |                                       | Cust. Ref.<br>Réf. du client                 |                                |         |
| BIL          | -           |                    |                                       | Serial No.<br>No. de série                   |                                |         |
| TERM. BORNES | H1 H2       |                    |                                       | Part No.<br>No. de pièce                     | C1F005CES                      |         |
|              | VOLTS       | CURRENT<br>COURANT | % RATED VOLTAGE<br>% TENSION NOMINALE | CONNECTION EACH PHASE<br>CONNEXION PAR PHASE | Phase                          | 1       |
|              |             |                    |                                       |  | kVA                            | 5       |
|              |             |                    |                                       |  | TYPE                           | Q       |
|              |             |                    |                                       |  | Cooling<br>Refroidissement     | ANC     |
|              |             |                    |                                       |  | Temp. Class<br>Classe de Temp. | 180 °C  |
|              |             |                    |                                       |  | Frequency<br>Fréquence         | 50/60Hz |
|              |             |                    |                                       |  | Impédance %<br>@ 135 °C        | 4.42    |
| LV/BT        | 120/240V    |                    |                                       | Encl. Type<br>Type de boîtier                | 3R                             |         |
| BIL          | -           |                    |                                       | Wt<br>Poids                                  | lbs 115                        |         |
| TERM. BORNES | X4 X2 X3 X1 |                    |                                       |  |                                |         |

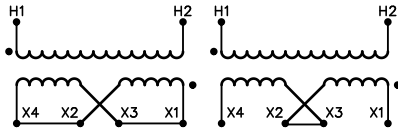

ELECTROSTATIC SHIELD

400001344



TITLE: 1PH DISTRIBUTION TRANSFORMER  
NAMEPLATE INFORMATION

|     |          |    |            |            |
|-----|----------|----|------------|------------|
| 1   | 21/07/13 | PP | EDB UPDATE | DES: LCEN  |
| NO. | DATE     | BY | REVISION   | SCALE: NTS |

SHEET 1 OF 2

EDBC1F005CES

FRONT VIEW

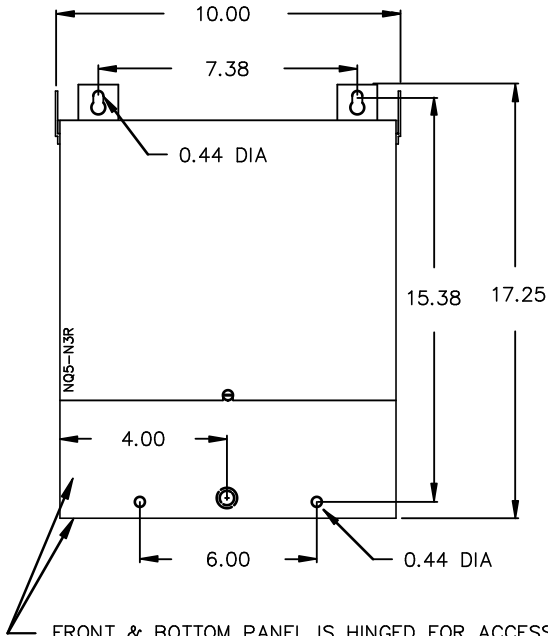

SIDE VIEW

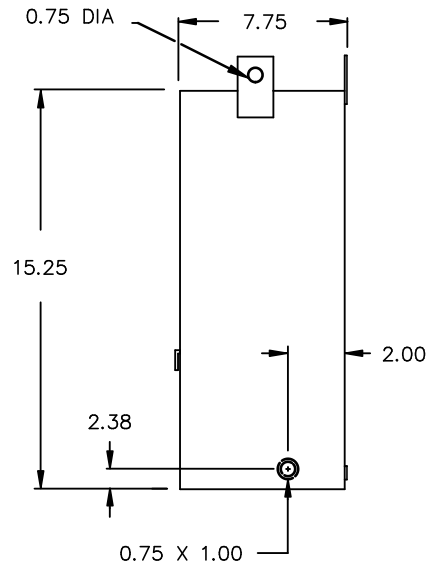

FRONT & BOTTOM PANEL IS HINGED FOR ACCESS TO TERMINALS, BOTTOM MOUNTING HOLES AND REAR KNOCKOUT.

All Dimensions in inches

ENCLOSURE COLOR : ANSI 61 GREY – OUTDOOR

CUSTOMER NOTES:

- HV1 TERMINATED AT LEADS
- LV1 TERMINATED AT LEADS



TITLE: 1PH DISTRIBUTION TRANSFORMER

|     |          |    |            |            |
|-----|----------|----|------------|------------|
| 1   | 21/07/13 | PP | EDB UPDATE | DES: LCEN  |
| NO. | DATE     | BY | REVISION   | SCALE: NTS |

SHEET 2 OF 2

EDBC1F005CES